

# PRE-QUALIFICATION DOCUMENTS



شركة مكونات البناء ذ.م.م.  
BUILDING COMPONENT SOLUTIONS (LLC)



## OUTLINE

1. INTRODUCTION
2. VISION AND MISSION
3. ORGANIZATION CHART
4. ANNUAL PRODUCTION CAPACITY
5. BCOMS FACTORY
6. BCOMS SERVICES
7. MARKET
8. BCOMS MAJOR PROJECTS
9. MAJOR RAW MATERIALS SUPPLIERS
10. GREEN PRODUCTS
11. PANEL SPECIFICATIONS AND ACCESSORIES
12. BCOMS PIR SANDWICH PANELS
13. BCOMS MINERAL WOOL INSULATED PANEL
14. QUALITY POLICY
15. CERTIFICATES
16. AIR INFILTRATION AND WATER PENETRATION TEST
17. APPROVALS

## INTRODUCTION

Building Component Solutions LLC (BCOMS) is a unit of Zamil Industrial Investment Company-(ZIIC) established in 2008 with state of art continuous production line for manufacturing Polyisocyanurate (PIR) and Mineral Wool (MW) Insulated Sandwich Panels.

Note: In line with BCOMS continuous improvement process, BCOMS upgraded its production line to fabricate PIR (Polyisocyanurate) Sandwich panels in June, 2015.

Total Land Area	40,000 m <sup>2</sup>
Built Up Production Area	14,500 m <sup>2</sup>
Office Area	1,100 m <sup>2</sup>

# VISION AND MISSION

## VISION

To be the key player in supplying the most advanced and innovative high quality services and products for building envelopes including all related accessories and components for the building industry in the Middle East and North Africa.

## MISSION

To provide innovative and robust solutions and engineering services in addition to top quality products complying with the international standards to serve projects and customers in our region of operation in an environment of professionalism and high business ethics with continuous training for our employees to promote technical and professional performance and focus on customer needs which shall lead to motivated and focused employees on customer service and a satisfactory return on investment to our shareholders.

# ORGANIZATION CHART

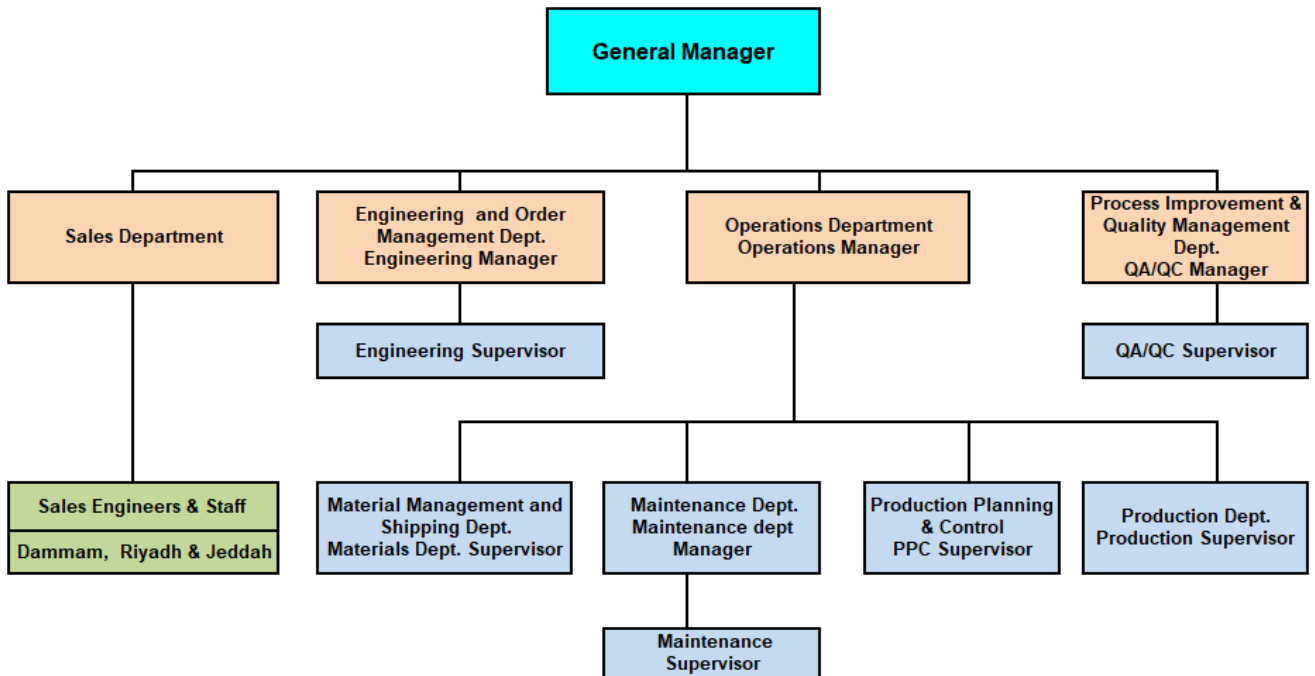

BCOMS

## PRODUCT RANGE

BCOMS provides complete solution for the building envelope i.e. Roof and Wall Sandwich Panels, Single Skin Sheeting, Purlins/Girts and all the required accessories.

- ✓ Insulated Polyisocyanurate (PIR) and Mineral Wool roof and wall Sandwich Panels
- ✓ Single Skin roof and wall sheets, related trims and accessories.
- ✓ Flat Sheets used for partition industries.
- ✓ Cold Formed Steel Sections
- ✓ Control Room for Factories and Porta-cabins
- ✓ Metal Decking
- ✓ Building accessories such as personnel doors, roll up doors ,sliding doors, Aluminum windows, Louvers, roof curbs, ridge vents, skylights etc.

Note: Polyurethane is a generic term, which covers a wide range of different formulations and applications derived from a reaction of diisocyanate with a polyol.

Both PIR & PUR Insulation foam belong to the family of “Polyurethane” insulation products.

BCOMS only supply Polyisocyanurate “PIR” Insulation foam sandwich panels.

# ANNUAL PRODUCTION CAPACITY

Sandwich Panels	3,000,000 m <sup>2</sup>
Single Skin Panels	1,500 MT
Trims & Accessories	800 MT

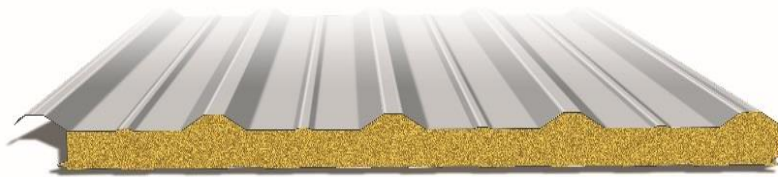

“PIR” Polyisocyanurate Panel

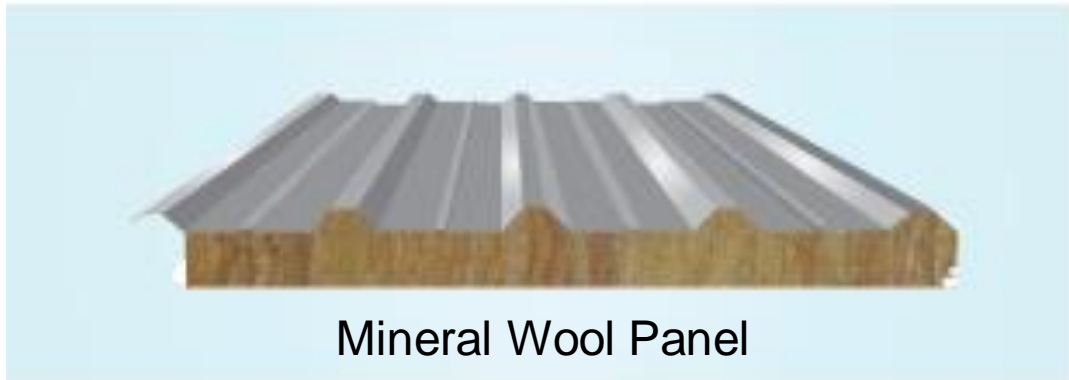

Mineral Wool Panel

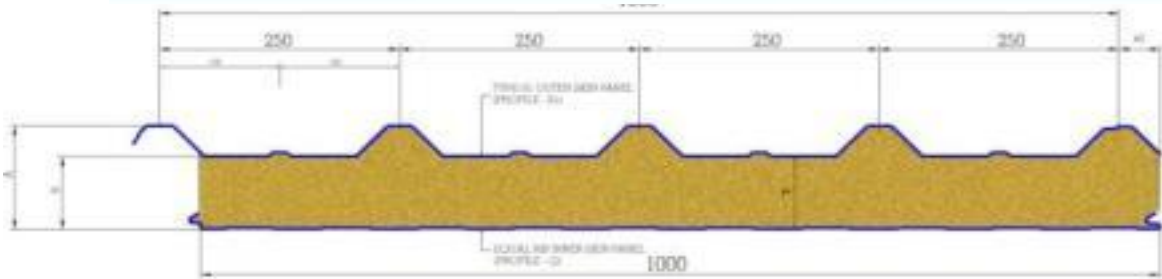

PROFILE NAME: TCSQ  
(TEMPCON ROOF & WALL PANEL)

# BCOMS FACTORY





**BCOMS**

BUILDING COMPONENT SOLUTIONS

# BCOMS FACTORY

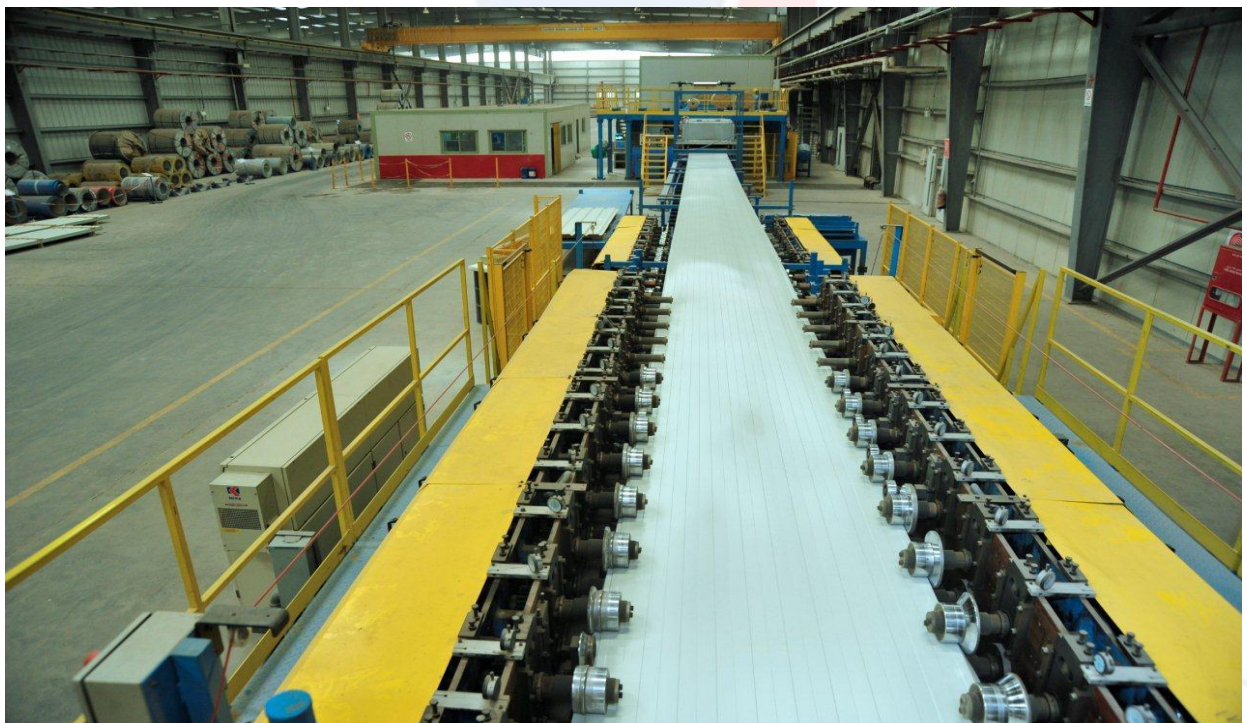



**BCOMS**

BUILDING COMPONENT SOLUTIONS

# BCOMS FACTORY



Zamil industrial

# BCOMS FACTORY



# BCOMS FACTORY



# BCOMS FACTORY



## BCOMS Services :

- 1) Engineering Department:  
preparation of Approval Drawings, Erection Drawings, Bill of Materials and Engineering detailing .
- 2) Order Management Department:  
Project Management and Execution.
- 3) Shipping Department:  
Shipping to all locations within KSA and for exporting to many countries
- 4) Wide network of approved Erectors to ensure Quality of installation for BCOMS products.
- 5) Installation work (for Special Projects).



**BCOMS**

BUILDING COMPONENT SOLUTIONS

# BCOMS SERVICES



Zamil Industrial

## BCOMS SERVICES



**Shipping in Dry Containers**



## Over Land Shipping



## MARKET POSITIONING

BCOMS has positioned itself in a front line among Insulation products companies in GCC based on its firm commitment to supply quality products and services in addition to its strong relationship with quality suppliers.

BCOMS Sandwich Panels are exported to Middle East and North Africa (MENA), GCC and Asian countries. BCOMS have engineered specialized container loading procedure which not only optimizes container loading but ensures delivering the panels at the destination port in excellent condition without any damages.



**BCOMS**

BUILDING COMPONENT SOLUTIONS

# MARKET POSITIONING



## MARKET SECTORS

### **Our Target markets/sectors are the following:**

- Industrial Steel Building sector.
- Commercial Buildings sector.
- Residential building sector.

*Note: The above sectors could be Governmental or Private.*

### **Our Customers**

- Contractors (Small contractors to multinational EPC contractors).
- End users such as SABIC, ARAMCO etc.
- Steel Building suppliers
- Distributors

*Note : Approved by SABIC, SCECO, ROYAL COMMISSION & MA'ADEN.*

## BCOMS MAJOR PROJECTS

Customer Name	Project Name	Location	Owner
DODSAL ENGINEERING AND CONSTRUCTIONS PTE. LIMITED	GC-31-KUWAIT	KUWAIT	KUWAIT OIL COMPANY (KOC)
AL-RAJHI FOAM & PLASTIC FACTOREIS	WATER FACTORY	RIYADH, K.S.A	AL-RAJHI FOAM & PLASTIC FACTOREIS
UNITED FOOD INDUSTRIES CORP.	DEEEMAH CAKE FACTORY	RIYADH, K.S.A	DEEEMAH CAKE FACTORY
OTHMAN SALEH AL GHAMDI CONTG.	KIA CENTRAL WAREHOUSE	DAMMAM PORT, K.S.A	KIA
BAJA TRADING	BAJA FOOD INDUSTRIES	SUDAIR, K.S.A	BAJA FOOD INDUSTRIES
IMPERIAL TRADING & CONTRACTING	3 NOS. WAREHOUSES 1 , 5 , & 7	DOHA, QATAR	-
KHAMIS AL SHARJAH CONTG. CO.	AL-SAFI DANONE WAREHOUSE	AL KHARJ, K.S.A	AL SAFI DANONE
MEDIA LINK CONTRACTING	BOUDI FACTORY	SUDAIR, K.S.A	-
Saudi Amana Contracting	Al Rabie Cold warehouse - Jeddah	AL-KHARJ	Al Rabie Company
Freyssinet Saudi Arabia	Jet Propulsion Center Project	Jeddah	Kking Abdulaziz new airport

## BCOMS MAJOR PROJECTS

*Extra Electronics,  
Al Khobar*



# BCOMS MAJOR PROJECTS

*Obaikan Glass Factory, Yanbu*

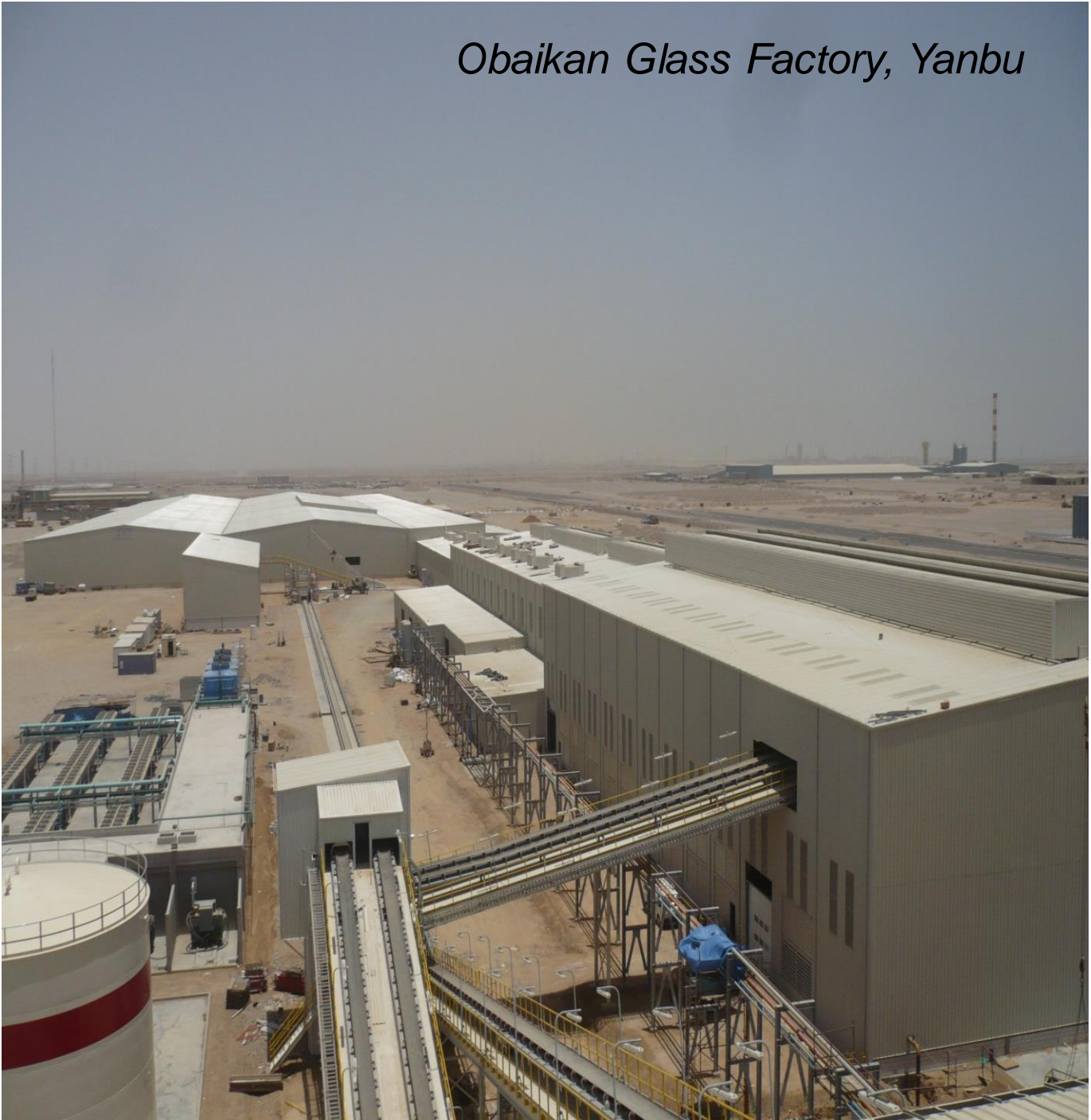

# BCOMS MAJOR PROJECTS

*Warehouse, Egypt*



## *Chloride Factory*



*Tasdeer Project, Jeddah*



# MAJOR RAW MATERIAL SUPPLIERS

## Steel Pre-painted Coils

UNISTEEL, Taiwan.

UMC (United Metal Coating),Dubai.

UNION STEEL, Korea.

UNICOIL (Universal Metal Coating Co. Ltd.), KSA.

## Aluminum Coils

GARMCO (Gulf Aluminum Rolling Mill Co.), Bahrain

Profile RH Factory, UAE

## Chemicals

APC-Arabian Polyol Co., KSA (A unit of Huntsman, Germany).

ACC-Arabian Chemical Co., KSA ( A unit of DOW Chemicals).

BAYER( Pearl Covestro Polyurethane Systems LLC)

BASF- KANOO Polyurethanes LLC

## STRATEGIC AND ENVIRONMENTAL ACHIEVEMENTS

BCOMS' aim is to be among the leaders in developing the industry in accordance with highest international standards in terms of protecting the environment.

- BCOMS became the first panel supplier in Kingdom of Saudi Arabia to use environmental friendly “n-Pentane” blowing agent and hence producing green panels as part of our ecological approach in products and operations.
- BCOMS is a founding member of the Eco-Commercial Building Program in the Middle East.
- BCOMS implemented in-house Safety, Health and Environment Management System (SHEMS).
- BCOMS is certified by the Presidency of Metrology and Environment (PME) in Saudi Arabia.

## GREEN PRODUCTS

BCOMS has focused on producing products with a long life cycle and used recyclable material.

BCOMS products are 'green' in two ways and they contribute to a more sustainable use of natural resources .

- Our high quality Polyurethane and Mineral Wool insulation lead to saving energy required for Air Conditioning and therefore contributes in reducing energy consumption and CO2 emission .
- "PIR" foam is recyclable.

The use of environment friendly blowing agent "Pentane" has "zero" Ozone Depleting Potential (ODP) value.

# PANEL SPECIFICATIONS & ACCESSORIES

## Panel Specification & Accessories



[www.bcoms.com](http://www.bcoms.com)

# PANEL SPECIFICATIONS & ACCESSORIES

## Material Specification For Sandwich & Single Skin Panels

BCOMS supply Sandwich panels & Single Skin for Roof & Wall sheeting in two different base metals i.e Steel and Aluminum.

### Steel Panels

Steel Panels are available in nominal skin thickness of 0.5mm & 0.7mm in Zinalume & Galvanized primer coating.

Zinalume steel panels conform to ASTM A 792M GRADE3458. This panels are coated with corrosion resistant Zinc-Aluminum alloy metallic coating AZM150 through a continuous hot-dip process.

Galvanized steel panels confirms to ASTM A653M Grade B (LFQ) with metallic coating Z275 (G90) through a continuous hot-dip process.

Steel base metal is used for single skin panels and for outer & inner skin of sandwich panels.

### Aluminum Panels

Aluminum panel confirms to ASTM B 209M ALLOY 3003/3105(H26) and is available in nominal thickness of 0.5mm & 0.7mm.

### Finish Coating of panels

BCOMS standard pre-painted panel is a Modified polyester polymer coated over Zinalume or Galvanized steel & Aluminum substrate. Nominal thickness of finish coating is 25 microns of high durability modified polyester polymer applied on the exterior (weather) face and 5-7 microns of plain polyester applied on the interior face.

Panels with modified polyester polymer finish are stocked in all BCOMS standard colors.

BCOMS also offers high performance Polyvinylidene Fluoride well-known as PVF2 (equivalent to Kynar 500) coating applied over Zinalume or Galvanized steel. It is a Pre-Painted panel with nominal finish thickness 25 microns of Polyvinylidene Fluoride on the exterior (weather) face and 5-7 microns of plain polyester on the interior face.

This paint system provides more protection to the panel in terms of longer life and long-term color and gloss finish durability.

### Panel Profiles

#### Single Skin Roof and Wall panels

"Type-S1" single skin profile in steel and aluminum is BCOMS standard roof panel. It is also used as wall panel. "Type-S1" is a superior structural panel whose profile is designed to withstand heavy loads, such as roof snow load and uplift loads resulting from high velocity (cyclonic) winds.

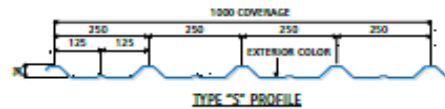

### Sandwich Panels

BCOMS sandwich panel is a composite panel consisting of two skins and a polyurethane foam core.

The exposed outer skin is roll formed from the steel or aluminum coils and the inner skin is made up of the same material as outer skin in addition to an "Aluminum foil" option.

Polyurethane core consists of sprayed polyurethane foam (PUR) or the fire rated polyisocyanurate foam (PIR) with density of 38 - 40KG/m<sup>3</sup>. Polyurethane foam has a thermal conductivity of K=0.022W/m<sup>2</sup>K measured at 25°C

Sandwich panels are available in two different types:

- 1) Tempcon sandwich panels (TCSQ) that are produced using rigid polyurethane foam core with external and internal sheet in steel or aluminum and profile of outer skin is Type-S1 & profile of inner skin is Type-Q. TCSQ panels are suitable for roof and wall of all building applications.

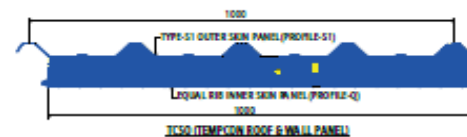

- 2) Temparch Sandwich panels (TA) are aesthetic wall panels also produced using rigid polyurethane foam core with external and internal sheet in steel or aluminum. Temparch sandwich panels have a unique detail to conceal fasteners and are therefore more suitable for walls & interior partition in showrooms, hypermarkets, shopping malls and commercial buildings.

Moreover, panels can be specially ordered based on cus-

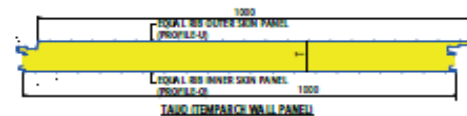

tomers specifications & requirements to meet a wide range of base metal specifications, coating finish, color and thickness.

Consult our sales dept. for complete information on price and delivery period.

# PANEL SPECIFICATIONS & ACCESSORIES

## Flashing ,Trims & Accessories for Roof & Walls:

Flashing & Trims are sheet metal closures designed primarily to provide weather tightness and neat appearance at corners and junctions of the buildings.

We supply appropriate flashing & trims as per the building requirements. Flashing, trims and other accessories are produced using same materials as used for roof & wall sheeting.

We also supply Eave gutters, downspouts, curved eaves, ridge

panels and other related accessories which contribute to the function, tightness & completeness of the building and enhance the overall appearance of the building.

BCOMS standard flashings, trims and accessories at Roof & Walls are shown in the below drawings.

Moreover BCOMS can supply any type of flashing/trims to suit any desired requirement of the customer.

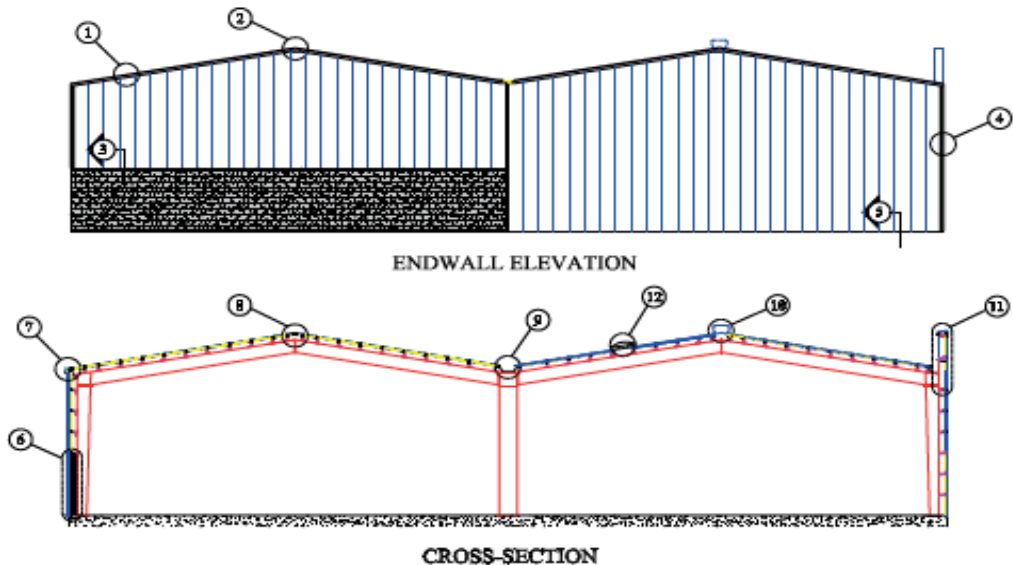

### TYPICAL FLASHING AND TRIMS AND ACCESSORIES AT ROOF AND WALLS

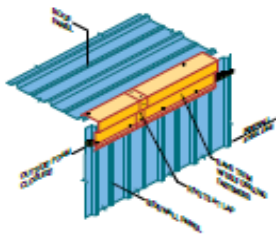

Detail-1: Eave Trim

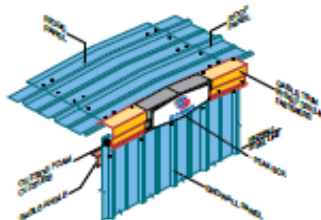

Detail-2: Gable Trim

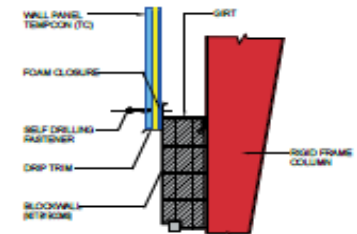

Detail-3: Drip Trim

# PANEL SPECIFICATIONS & ACCESSORIES

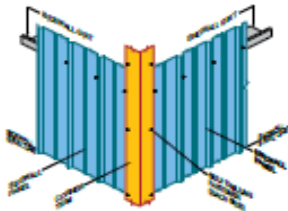

Detail-4: Corner Trim

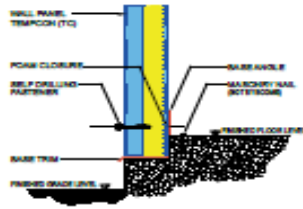

Detail-5: Base Trim

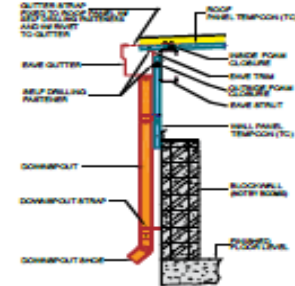

Detail-6: Downspout

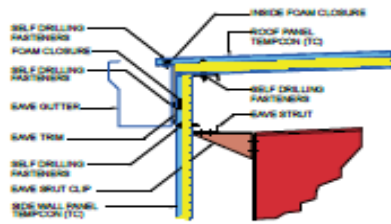

Detail-7: Eave Gutter



Detail-7: Curved Eave (Optional)

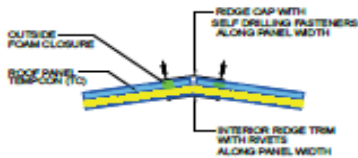

Detail-8: Ridg Cap & Ridge Trim

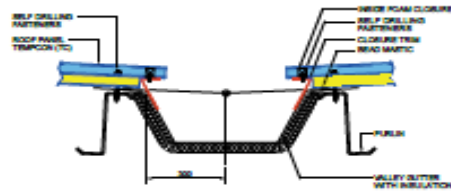

Detail-9: Valley Gutter

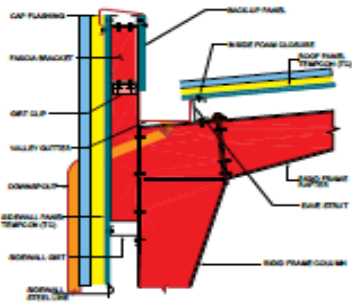

Detail-11: Parapet Fascia

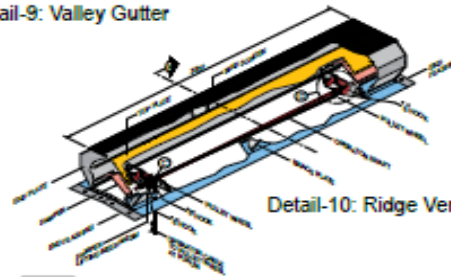

Detail-10: Ridge Ventilator

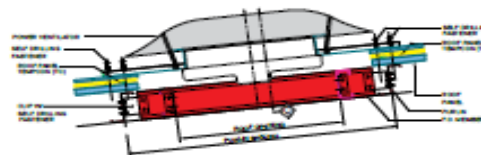

Detail-12: Power Ventilator

# PANEL SPECIFICATIONS & ACCESSORIES

## Sundry Items:

Below mentioned sundry items forms a basic part of our scope of supply & are supplied along with sheeting materials.

**Fasteners:** Standard Carbon steel screws with washers as per the requirement are supplied along with sheeting.

**Pop Rivets:** Standard pop rivets for joining light gauge trims



and flashings.

**Foam Closure:** Foam closures are standard supplied sundry parts for weather tight sealing between panels and trims at the eave, gable, base, canopy, ridge as well as above blockwall areas. The type of foam closure supplied depends on the panel profile supplied.

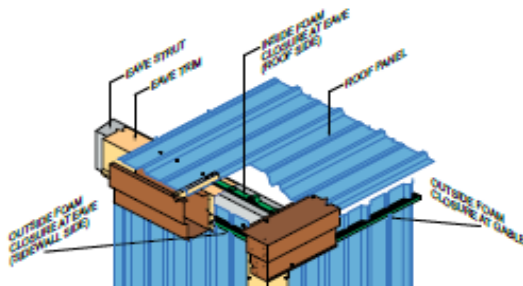

Foam closure are made of rigid polyethylene foam that has very high resistance to ultraviolet rays, can withstand harsh environments and resists some aggressive chemical attacks.

**Bead Mastic:** It is a high performance tacky elastic butyl tape with silicone release paper designed to bond panels and valley gutter. It is engineered to withstand extreme roof temperature while offering low temperature compressibility and resistance to cold flow.

**Flowable Mastic:** It is a high performance solvent release pigmented acrylic compound sealant ideal for sealing critical laps in gutters, downspouts etc. It remains ductile in the presence of ultraviolet and infrared radiation, making it an excellent general purpose sealant.

We maintain a steady & up-to-date stock of all these items to ensure immediate delivery.

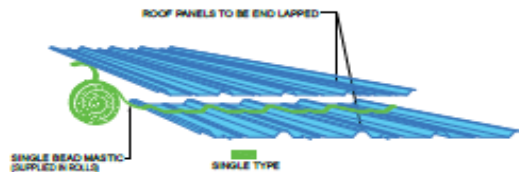

# PANEL SPECIFICATIONS & ACCESSORIES

## Panel Colors

Panels are available in BCOMS standard colors as listed herein. We maintain a steady stock of all the standard color materials and it can be supplied within a very short delivery period.

Moreover BCOMS can supply panels in any RAL color as per requirement of the customer. Consult our sales dept. for complete information on price and delivery period.



Frost White



Arabian Beige



Leaf Green



Daisy Yellow



Flame Red



Cactus Green



Royal Blue



Silver Metallic



Grey Blue Metallic



Shasta Blue

# PANEL SPECIFICATIONS & ACCESSORIES



شركة مكونات البناء ذ.م.م.  
BUILDING COMPONENT SOLUTIONS (LLC)  
P.o. Box 14441, 2nd Industrial Estate,  
Dammam 31424, KSA  
Phone: (966 13) 812 4571 /72/73  
Fax: (966 13) 812 4579

**Dammam Sales Office:**  
Phone: (966 13) 812 4571 /72/73  
Fax: (966 13) 812 4579

**Riyadh Sales Office:**  
Phone: (966 11) 472 5555/5250  
Fax: (966 11) 476 6729

**Jeddah Sales Office:**  
Phone: (966 12) 660 0012  
Fax: (966 12) 660 9707

e-mail: [marketing@bcoms.com](mailto:marketing@bcoms.com)  
[www.bcoms.com](http://www.bcoms.com)



## BCOMS PIR SANDWICH PANEL



شركة مكونات البناء ذ.م.م.  
BUILDING COMPONENT SOLUTIONS (LLC)

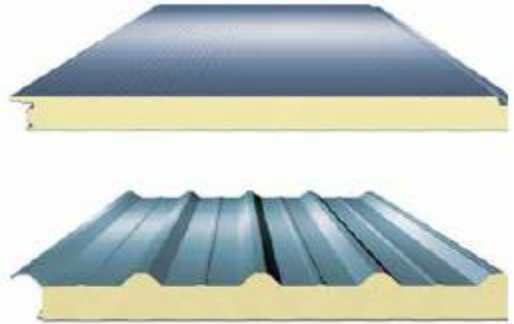

## Vision and Mission

### Vision and Mission

#### Our Vision

To be the key player in supplying the most advanced and innovative high quality services and products for building envelopes including all related accessories and components for the building industry in the Middle East and North Africa.

#### Our Mission

To provide Innovative and robust solutions and engineering services in addition to top quality products complying with international standards to serve customers in our region of operation in an environment of professionalism and high business ethics with continuous training for our employees to promote technical and professional performance and focus on customer needs which shall lead to motivated and focused employees and a satisfactory return on investment to our shareholders.

# BCOMS

**Building Component Solutions LLC (BCOMS) – this sector of Zamil Industrial was formed in 2008. BCOMS manufactures and supplies construction products and building envelope material.**



BCOMS is the largest supplier of Sandwich panels in Saudi Arabia. The company's sandwich panels are exported to all Middle East & North Africa (MENA), GCC and Asian countries.

BCOMS factory is located in Dammam Second Industrial City. The company produces more than 1,500,000 square meters annually of sprayed Polyisocyanurate (PIR) foam and mineral wool sandwich panels in compliance with the international standards and norms. The continuous production process on double conveyor-belt adopted by BCOMS is considered as the most innovative process for manufacturing sandwich panels.

BCOMS is committed and faithfully adhering to the ISO 9001 standards and other requirements, working continuously to improve product quality.

In addition to sandwich panels, BCOMS also produces single skin roof and wall panels, related trims and accessories. The company also supplies building accessories, such as personnel doors, roll up doors, sliding doors, aluminum windows and louvers, ridge ventilators and roof curbs.

The company also offers engineering services and turnkey solutions for the supply and installation of the roof covering and wall cladding, including the secondary members and all related accessories for new buildings as well as retrofitted buildings.

During the production of sandwich panel, no ozone depleting gases are used. BCOMS uses n-Pentane as the blowing agent during production of its panels. Pentane is a Zero ODP gas with no adverse effect on the ozone layer. The hydrochlorofluorocarbon (HCFC) gases used in some older, obsolete production types have a negative effect on the ozone layer, efficiently destroying the ozone molecules in the atmosphere.

BCOMS has become the first panel supplier in the Kingdom of Saudi Arabia to use the environmentally friendly n-Pentane blowing agent and hence producing green panels as part of our ecological approach in products and operations.

BCOMS is a member of the Eco-Commercial Building Program with Bayer Material Service, dedicated to the supply of green products to ecological buildings in Middle East.

## BCOMS Sandwich Panel

“Polyisocyanurate (PIR) insulated panel system for roofs & walls”

**BCOMS** Sandwich panel is a composite panel consisting of two skins and a Polyisocyanurate (PIR) core. The exposed outer skin is roll formed from steel or aluminium coils, where the inner skin is made up of the same material in addition to a Fiber Reinforced Liner (FRL) option.

**T**he outer and inner skins, in case of steel and aluminium coils, are available in different profiles, thickness, coatings and colours to suit the different requirements and exposure conditions in addition to the aesthetic look of the building. The core consists of sprayed Polyisocyanurate (PIR) foam, fire rated (Class 1 in accordance with ASTM E-84) with n-Pentane blowing agent.

**T**he thermal properties of the panels shown in this brochure are based on the average foam thickness, i.e. excluding the ribs of the corrugation and the contribution of the outer and inner skin. More detailed calculation of the thermal properties can be provided upon request based on the outer and inner skin material and thickness and including the calculation of the thermal properties of the corrugation ribs.

**T**he continuous production on double conveyor-belt process adopted by BCOMS is considered as the most innovative process for manufacturing sandwich panels nowadays. The continuous production process ensures the best mechanical properties of the insulant due to the strong adhesion of the foaming reaction mixture to both layers of the panel under the influence of heat and free-rise foaming pressure in addition to a considerably higher bending resistance.

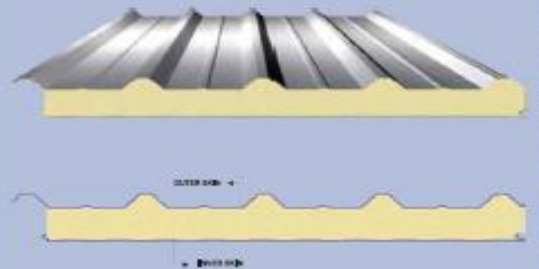

### Features

- ✓ Excellent thermal insulating properties
- ✓ Cost-efficient processing
- ✓ Chemical and biological resistance
- ✓ Light weight and durable
- ✓ Fast and easy to install
- ✓ Nice aesthetic features
- ✓ High strength and rigidity
- ✓ Non-water absorbent
- ✓ Dimensional stability
- ✓ Environmentally friendly

# BCOMS PIR SANDWICH PANEL



## Application

- Factories
- Commercial Showrooms and Offices
- Warehouses, Convention Halls and Distribution Centers
- Aircraft Hangers and enclosed Sports facilities
- Restaurants and Schools
- Airport terminals
- Museums and theaters
- Shopping Malls and Supermarkets / Hypermarkets
- Interior wall partitioning



## Available Lengths

Standard lengths range from 3 to 12 meters. Minimum lengths can start from 1.5 m if panels are cut flush without overlap. It is recommended to limit the panel length to maximum 10.0 meters for safe handling on site.



# TEMPCON PANELS

## TEMPCON PANEL

**T**empcon sandwich panels are produced using rigid Polyisocyanurate (PIR) foam core with external and internal sheets in steel or aluminum of varying thickness, coatings and colors. Tempcon is a durable sandwich panel, particularly in industrial buildings and are suitable for roof and wall for all building applications.

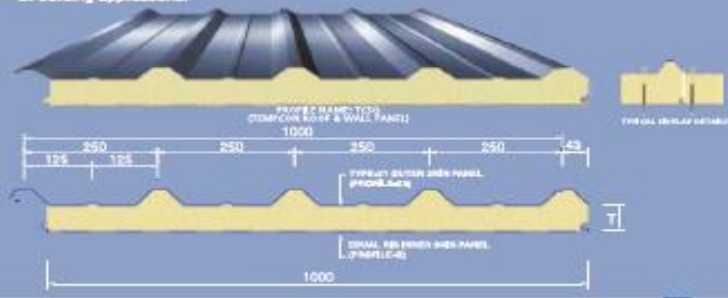

## Dimensions & Thicknesses

**T**empcon sandwich panel is available in a single outer profile type in both steel and aluminium in combination of the below listed inner skin types; the insulating core can be produced in various thicknesses and thermal insulation values.

## Thermal Properties

Panel ID	Skin Type		Name Code	Core "T" (mm)	Thermal Transmission U-Value W/m <sup>2</sup> K	Thermal Resistance R-Value m <sup>2</sup> K/W
	Outer	Inner				
TC	Type-S	Equal Rib (Q)	TCSQ-30	30	0.733	1.364
			TCSQ-40	40	0.550	1.818
			TCSQ-50	50	0.440	2.273
			TCSQ-75	75	0.293	3.409
			TCSQ-100	100	0.22	4.545
			TCSQ-120	120	0.1833	5.455
			TCSQ-160	160	0.1468	6.822
			TCSQ-200	200	0.1100	9.090
			Fiber Reinforced Liner (O)	TCSO-30	30	0.733
		TCSO-40		40	0.550	1.818
		TCSO-50		50	0.440	2.273
		TCSO-75		75	0.293	3.409
		TCSO-100		100	0.22	4.545
		TCSO-120		120	0.1833	5.455
		TCSO-160		160	0.1468	6.822
		TCSO-200		200	0.1100	9.090

The U-Values in the above table is measured at 25°C and thermal conductivity K= 0.022 W/m °K

## TEMPARCH PANEL

### TEMPARCH PANEL

**T**emparch sandwich panels are produced using rigid Polyisocyanurate (PIR) foam core with external and internal sheets in steel or aluminum of varying thickness, and are suitable for walls for all building applications, interior partition and cold stores.



### Dimensions & Thicknesses

Panel ID	Outer Skin		Inner Skin		Sandwich Panel		
	Skin Name	It	Skin Name	It	Name – (Thickness)		
TA	Micro Rib	W	Equal Rib	-	TAWG-50	TAWG-75	TAWG-100
			Fiber Reinforced Liner	TAWG-40*	TAWG-60	TAWG-75	TAWG-100
	Equal Rib	U	Equal Rib	-	TAUG-50	TAUG-75	TAUG-100
			Fiber Reinforced Liner	TAUG-40*	TAUG-60	TAUG-75	TAUG-100
V - groove	V	Equal Rib	-	TAVG-50	TAVG-75	TAVG-100	
		Fiber Reinforced Liner	TAVG-40*	TAVG-60	TAVG-75	TAVG-100	

Note: \*- This thickness is available for TEMPARCH Wall Panel with Fiber Reinforced Liner (FRL) only.

### Thermal Properties

Panel Thickness (mm)	Thermal Transmission U-Value (W/m <sup>2</sup> K)	Thermal Resistance R-Value (m <sup>2</sup> K/W)
40	0.550	1.818
60	0.367	2.724
75	0.293	3.409
100	0.22	4.545

The U-Values in the above table is measured at 25°C and thermal conductivity K= 0.022 W/m.°K

### Skin Profiles

The skin types mentioned in all sandwich panel types are shown below to illustrate dimensions in detail.



\* : These Computations can be used for interior skin after consulting our representative.

# BCOMS PIR SANDWICH PANEL



## Panel Finish

- **Base Metal:**

- Galvalume coated steel conforming to ASTM A 792M Grade 345B. These panels are coated with corrosion resistant Zinc-Aluminum alloy metallic coating AZM160 through a continuous hot-dip process.
- Galvanized coated steel conforming to ASTM A653M Grade B (LFC) with metallic coating Z275 (G90) through a continuous hot-dip process.
- Aluminum conforming to ASTM B 209M Alloy 3003 / 3105.

- **Paint Finish**

- Painted Exterior surface coating of 25 microns of:
  - Epoxy primer with a high durability modified polyester polymer
  - Premium durability polyvinylidene fluoride well known as PVP2 (equivalent to Kynar 500) liquid coating meeting AAMA 2905-98 standards.
- Painted interior surface coating of 5 – 7 microns of primer suitable for foam application.

For other substrate or paint specification, please contact BCOMS sales

# BCOMS Standard Panel Color Specification



Please refer to BCOMS panel chart, as actual colors may vary from these printed samples.

Material Availability		Aluminum Panel		Pre-Painted Steel panels with thickness/ thickness in metric and all other available polymer panel finish (ppp) or the other type											
		Aluminum Frost White	Frost White	Aluminum Grey	Dark Grey	Light Blue	Flame Red	Dark Blue	Silver Metallic	Grey Blue Metallic	Light Green	Light Green	Light Green	Light Green	
Panel Type	Tickness	Alum(FW)	FW	AG	DB	FB	FR	DB	DM	DM	DM	DM	DM	DM	DM
Trapezium Sandwich Panel (TSC)	Outer Size	5.7mm	⬆	⬆	⬆	⬆	⬆	⬆	⬆	⬆	⬆	⬆	⬆	⬆	⬆
	Inner Size	5.7mm	⬆	⬆	⬆	⬆	⬆	⬆	⬆	⬆	⬆	⬆	⬆	⬆	⬆
Trapezoid Sandwich Panel (TALC)	Outer Size	5.7mm	⬆	⬆	⬆	⬆	⬆	⬆	⬆	⬆	⬆	⬆	⬆	⬆	⬆
	Inner Size	5.7mm	⬆	⬆	⬆	⬆	⬆	⬆	⬆	⬆	⬆	⬆	⬆	⬆	⬆

- Notes:**
1. Steel Panel with "XPD" (high performance Polyvinylidene Fluoride well known as PVDF) finish is available in BCOMS stock in "Frost White" color.
  2. Aluminum Panel with "XFW" finish is available in BCOMS stock in "Frost White" color.
  3. Aluminum Panel with "XPD" finish is available upon request.
  4. Other standard and non-standard "RAL" color, thickness, substrate and paint finish can be supplied upon request.
- Please consult BCOMS sales for last three, price details and for all other non-stock material.

# BCOMS PIR SANDWICH PANEL

E-mail: [marketing@bcoms.com](mailto:marketing@bcoms.com)  
[www.bcoms.com](http://www.bcoms.com)



**Building Component Solutions (LLC)**  
 P.O. Box 14441  
 Second Industrial City,  
 Dammam 31424  
 Saudi Arabia  
 Phone (966 13) 812 4571 / 72  
 Fax (966 13) 812 4579

**Dammam Sales Office**  
 Phone (966 13) 812 4571 / 72 / 73  
 Fax (966 13) 812 4579

**Riyadh Sales Office**  
 P.O. Box 251 Riyadh, 11411  
 Phone (966 11) 472 5555 / 5250  
 Fax (966 11) 476 6729

**Jeddah Sales Office**  
 P.O. Box 8076, Jeddah 21482  
 Phone (966 12) 660 0012  
 Fax (966 12) 660 9707



Rev.# 13 July 2015

## BCOMS MINERAL WOOL INSULATED PANEL



شركة مكونات البناء ذ.م.م.  
BUILDING COMPONENT SOLUTIONS (LLC)



Mineral wool insulated panel  
system for roofs & walls

# BCOMS MINERAL WOOL INSULATED PANEL

## Tabel of Contents

About Mineral Wool .....	4
Why Use Mineral Wool .....	4
Mineral Wool Sandwich Panel .....	5
Mineral Wool Panel Characteristics .....	6
Thermal Insulation .....	6
Acoustic insulation .....	8
Fire Resistance .....	11
Environment Friendly .....	12
Advantages of Mineral Wool Sandwich Panels .....	14
Mineral Wool Sandwich Panels Sustainability Qualities .....	14
Application .....	15
Available Lengths .....	15
FIRECON PANELS .....	16
FIREWALL PANELS .....	17
Panel Finish .....	20
We From Inside .....	21

# BCOMS MINERAL WOOL INSULATED PANEL

## About Mineral Wool

Mineral wool is a premium insulation made from volcanic rock melted at high temperatures and spun into a mat of fine fibers. Mineral wool only burns at temperatures in excess of 1000°C so in effect provides a fire barrier for building envelope.

The mineral wool insulation used in BCOMS sandwich panels is certified by regional and international entities.

## Why Use Mineral Wool

Mineral wool is a high performing material in regards to thermal insulation, acoustic properties and fire protection.

Thermal insulation and energy saving is one of the main concerns of modern civilization for its positive role in conserving the environment and natural resources. Scientific research and studies proved that use of thermal insulation in buildings will dramatically reduce the heat transferred through the walls and roofs. Hence it has a major contribution in saving electrical power and energy needed to cool and heat the buildings.

Professional studies proves that the thermal insulation cost of a building will not exceed 3.5% of its budget. However, this amount will be paid back in 4 - 5 years as a result of saving in the electricity bill.

04

BCOMS  
BROCHURE

## BCOMS MINERAL WOOL INSULATED PANEL

### Mineral Wool Sandwich Panel

Mineral wool sandwich panel adopts fibrous mineral wool as the core material glued to pre painted metal sheets as its surface layers on a state of the art continuous production line. Freshly formed panels are then passed through an enclosed temperature controlled conveyor press for curing before the final panels are ready to cut.

Since the metal sheets and the mineral wool are non-combustible, the mineral wool sandwich panel has excellent fireproof property.

BCOMS mineral wool sandwich panels can be used for roof and wall panels as well as internal partitions. MW panels are widely used for envelope of industrial and commercial buildings in addition to other specialized applications. Because of their fireproof, heat insulation and acoustic properties.

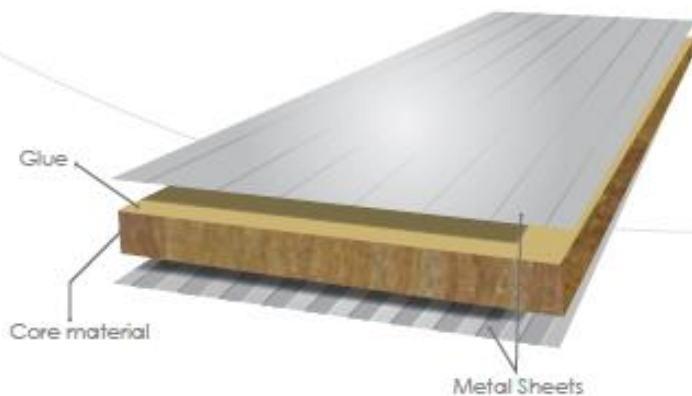

05

BCOMS  
BROCHURE

# BCOMS MINERAL WOOL INSULATED PANEL

## 1 Mineral Wool Panel Characteristics Thermal Insulation



## BCOMS MINERAL WOOL INSULATED PANEL



BCOMS Mineral wool panel helps to restrict heat transfer through building envelope thus reducing the demand for space heating and cooling energy. This in turn reduces a host of negative environmental impacts including the emissions of CO<sub>2</sub> and other pollutants such as sulfur dioxide (SO<sub>2</sub>) and nitrogen oxides (NO<sub>x</sub>).

07

BCOMS  
BROCHURE

# BCOMS MINERAL WOOL INSULATED PANEL

## 2 Mineral Wool Panel Characteristics Acoustic insulation



## BCOMS MINERAL WOOL INSULATED PANEL



# BCOMS MINERAL WOOL INSULATED PANEL

## Mineral Wool Panel Characteristics Acoustic insulation

The open cell structure of mineral wool makes it an ideal product as a sound absorber and acoustic insulator. Due to its high absorbing and insulating coefficients over a wide sound frequency range, the mineral wool panels provide significant improvement in the Sound Transmission Coefficient (STC) and Noise Reduction Coefficient (NRC>0.95).



The ability to absorb sound energy means reducing the noise transfer within the same building, across buildings, as well as between buildings and the external environment.

# BCOMS MINERAL WOOL INSULATED PANEL

## 3 Mineral Wool Panel Characteristics Fire Resistance



The most important characteristic of mineral wool panel is its exceptional fire protection; mineral wool is non-combustible and does not ignite. It has zero flame spread and does not generate toxic smoke and particles. It is therefore internationally specified as a fire rated material, with a fire rating of minimum 2 hours and classified as Non-Combustible Material according to EN ISO 1182, ASTM E136, and also EURO Class fire Rating of A1 in accordance with EN ISO 1182 and EN ISO 1716.

Mineral wool panels restricts the fire to spread from one zone to another; it also acts as a protection for load bearing elements in steel structures and thus prevents the building from collapsing under fire conditions.

11

BCOMS  
BROCHURE

# BCOMS MINERAL WOOL INSULATED PANEL

## 4 Mineral Wool Panel Characteristics Environment Friendly

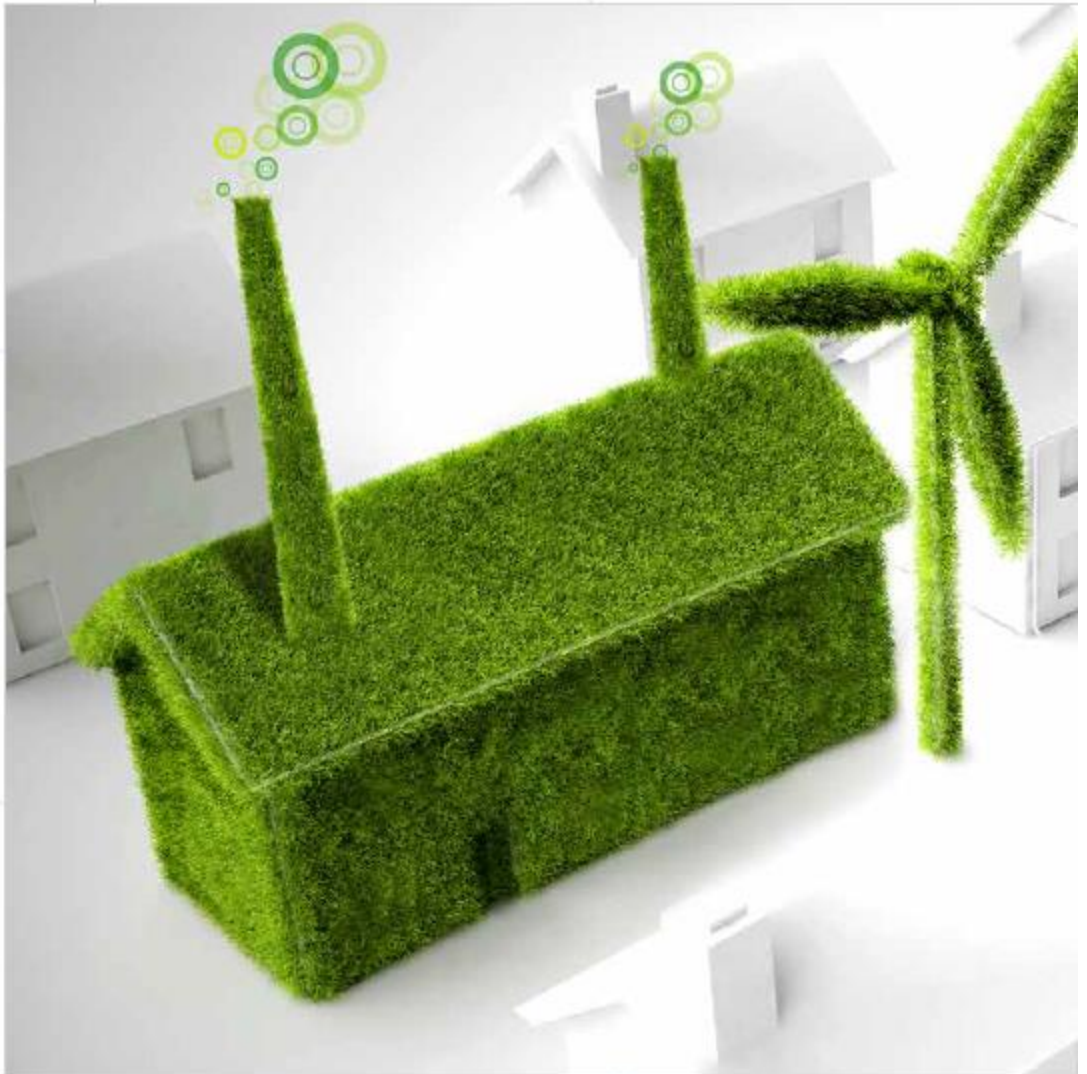

12

BCOMS  
BROCHURE

## BCOMS MINERAL WOOL INSULATED PANEL



Mineral wool insulation is one of the few building materials that saves energy in use and reduces the need for combustion of fossil fuels to provide energy for heating or cooling of buildings. The recycled content and recyclability of the material reduces waste disposal needs and saves valuable resources both now and in future. Mineral wool is 97% recyclable.

### Wider Benefits:

Beside the environmental benefits provided, using mineral wool panels can of course help to reduce energy costs for the buildings and contribute significantly to a comfortable and healthy indoor environment.

### Sustainability:

As an environment conscious company, BCOMS promotes the sustainable production and use of insulation and is committed to a continuous process of environmental impact.

13

BCOMS  
BROCHURE

# BCOMS MINERAL WOOL INSULATED PANEL

## Advantages of BCOMS Mineral Wool Sandwich Panels

- Outstanding thermal insulation
- Outstanding fire protection
- Excellent acoustic insulation
- High compressive strength
- Water repellent
- Recyclable
- Wide range of thicknesses
- Easy to handle and install
- Cost effective
- Low maintenance

14

BCOMS  
BROCHURE

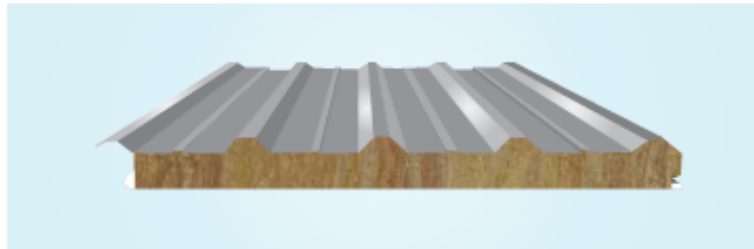

## BCOMS Mineral Wool Sandwich Panels Sustainability Qualities:

- Energy Efficient
- Positive net carbon footprint
- Fire Safe
- Noise Control
- Durable

# BCOMS MINERAL WOOL INSULATED PANEL

- Recyclable
- Made of renewable resources
- High resistance to mold and fungi
- No Hazardous flame retarders



## Application

Metal surface mineral wool sandwich panel is widely used in various types of buildings based on its excellent treats, such as:

- Industrial Buildings
- Ware Houses / Storages
- Non-residential buildings including Health, Education, Leisure Buildings, Exhibition Centers, Shopping Centers, Multiplexes, Airports, Stadiums and many more.
- Commercial buildings
- Residential Buildings

## Available Lengths

Standard lengths range from 3 to 12 meters. Minimum lengths can start from 1.5 m if panels are cut flush without overlap.

It is recommended to limit the panel length to maximum 10.0 meters for safe handling on site.

# BCOMS MINERAL WOOL INSULATED PANEL

## FIRECON PANELS

BCOMS Firecon sandwich panels are produced using mineral wool core with external and internal metal sheets in steel or aluminum of varying thickness, coating and colors.

Firecon is a durable sandwich panel, particularly in industrial buildings suitable for roof and wall for all building applications.

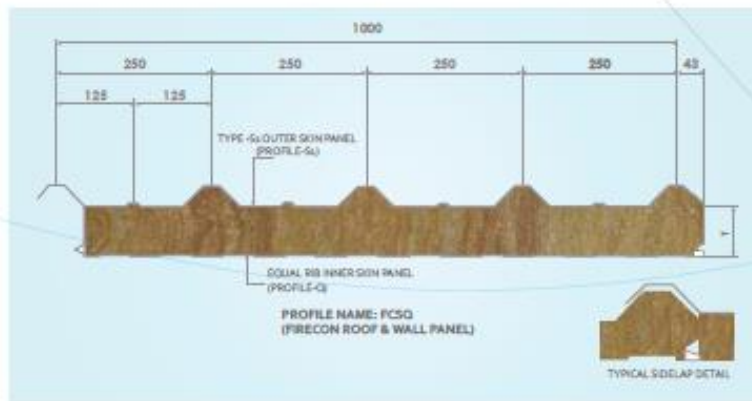

### Dimensions & Thicknesses

Firecon sandwich panel is available in a single outer and inner profile type in both steel and aluminum; the insulating core can be produced in various thicknesses and thermal insulation values as listed in below table.

### Thermal Properties

Panel ID	Skin Type		Name Code	Core "T" (mm)	Thermal Transmission U-Value* (W/m <sup>2</sup> .K)	Thermal Resistance R-Value m <sup>2</sup> K/W
	Outer	Inner				
FC	Type-S	Equal Rib (Q)	FCSQ-50	50	0.680	1.470
			FCSQ-75	75	0.453	2.206
			FCSQ-100	100	0.340	2.941
			FCSQ-120	120	0.283	3.530
			FCSQ-150	150	0.227	4.411

\* The U-Values in the above table is measured at 24°C and thermal conductivity K=0.034 W/m<sup>2</sup>K at 100 kg/m<sup>3</sup> density.

# BCOMS MINERAL WOOL INSULATED PANEL

## FIREWALL PANELS

BCOMS Firewall sandwich panels are produced using mineral wool core with external and internal metal sheets in steel or aluminum of varying thickness and are suitable for walls for all building applications, interior partitions.

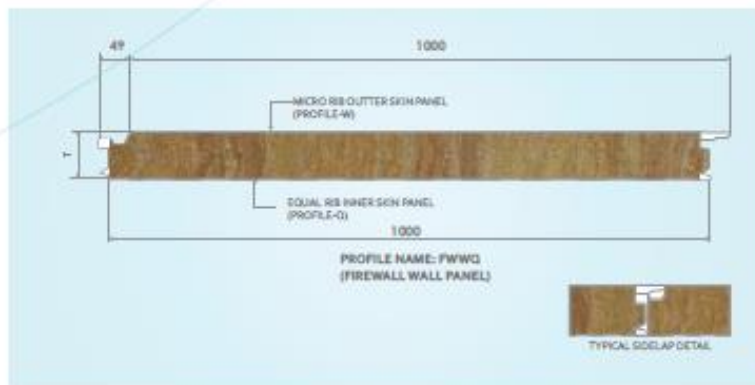

## Dimensions & Thicknesses

Panel ID	Outer Skin		Inner Skin		Sandwich Panel				Profile
	Skin Name	ID	Skin Name	ID	Name - (Thickness)				
FW	Micro Rib	W	Equal Rib	Q	[Micro Rib W / Equal Rib Q]				Micro Rib W
					FWWQ-75	FWWQ-100	FWWQ-120	FWWQ-150	Equal Rib Q
					[Equal Rib U / Equal Rib Q]				Equal Rib U
					FWUQ-75	FWUQ-100	FWUQ-120	FWUQ-150	Equal Rib Q
	Equal Rib	U	Equal Rib	Q	[Equal Rib U / Equal Rib Q]				Equal Rib U
					FWUQ-75	FWUQ-100	FWUQ-120	FWUQ-150	Equal Rib Q
					[Plain P / Equal Rib Q]				Plain P
					FWPQ-75	FWPQ-100	FWPQ-120	FWPQ-150	Equal Rib Q
	V-Groove	V	Equal Rib	Q	[V-Groove V / Equal Rib Q]				V-Groove
					FWVQ-75	FWVQ-100	FWVQ-120	FWVQ-150	Equal Rib Q

17

BCOMS  
BROCHURE

# BCOMS MINERAL WOOL INSULATED PANEL

## Thermal Properties

Panel ID	Panel Thickness	Thermal Transmission U-Value*	Thermal Resistance R-Value
	(mm)	(W/m <sup>2</sup> .K)	m <sup>2</sup> K/W
FW	75	0.453	2.206
	100	0.340	2.941
	120	0.283	3.530
	150	0.227	4.411

\* The U-Values in the above table is measured at 24°C and thermal conductivity K=0.034 W/m<sup>2</sup>K at 100 kg/m<sup>3</sup> density.

## Thermal conductivity values

Thermal conductivity values with typical figures shown below as tested in accordance with ASTM C177/C518 and DIN 52612 standards

Mean Temp °C	K-Value W/ m <sup>2</sup> K 100 kg/m <sup>3</sup>
24	0.034
50	0.038
100	0.044
150	0.050
200	0.058
250	0.067

## Acoustics Properties

Typical sound absorption figures are shown below in accordance with BS 3638 and ISO 0354

Hz	100 kg/m <sup>3</sup>
125	0.33
250	0.86
500	1.10
1000	1.10
2000	1.05
4000	0.98

## BCOMS MINERAL WOOL INSULATED PANEL

### High performance sound absorption for perforated Mineral Wool Panels

BCOMS Mineral Wool Acoustic Panels are engineered to suit specific roofing and Wall Cladding requirements, where the acoustic and sound absorption properties are the main characteristics of the panels in addition to the fire rating and thermal insulation properties.

The combination of optimized density, fiber direction and excellent fit provides a significant improvement in Class C type sound absorption when used together with apt Mineral Wool density (100kg/m<sup>3</sup>) and on perforated metal Galvanized sheets (Standard 1/8" Holes with 30% open area with 7/32" Staggered centres).

The Perforations can be optimized as per customer requirement on the Sound Transmission Coefficient (STC) values required.



19

BCOMS  
BROCHURE

# BCOMS MINERAL WOOL INSULATED PANEL

## Panel Finish

- **Base Metal coating:**
  - Galvalume coated steel conforming to ASTM A 792M Grade 345B. The metal sheets are coated with corrosion resistant Zinc-Aluminum alloy metallic coating AZM150 through a continuous hot-dip process.
  - Galvanized coated steel conforming to ASTM A653M Grade B with metallic coating Z275 (G90) through a continuous hot-dip process.
  - Aluminum conforming to ASTM B 209M Alloy 3003 / 3105.
  
- **Paint Finish**
  - Painted Exterior surface coating of 25 microns of
    - Epoxy primer and a high durability modified polyester polymer
    - Premium durability polyvinylidene fluoride well known as PVF2 (equivalent to Kynar 500) liquid coating meeting AAMA 2605-98 standards.
  - Painted interior surface coating of 5 – 7 microns of primer suitable for foam application.

20

BCOMS  
BROCHURE

# BCOMS MINERAL WOOL INSULATED PANEL

We From  
Inside



21

BCOMS  
BROCHURE

# BCOMS MINERAL WOOL INSULATED PANEL

22

BCOMS  
BROCHURE



# PME CERTIFICATE

## تصريح بيئي للتشغيل

المركز الوطني  
للمراقبة على الالتزام البيئي  
National Center for Environmental Compliance  
المملكة العربية السعودية



رقم الصادر	١٧٤٤٠
تاريخه	١٤٤٤ / ١١ / ١١ هـ

رقم الطلب	شركة مكونات البناء	أسم المنشأة
١٤٤٢/٦٩٥٤	ثانية	فئة
٠١٣٨١٢٤٥٧١	العنوان	المدينة الصناعية الثانية بالدمام
١٤٤٤٠	رقم المنشأة	٢٠٠٣٠٢٢٩٨٧
الدمام	الاحداثيات	N ٤٩,٩٧٦٦٠ ٢٧٩ ٢٧٣٩٨٧ E ٢٦,٢٦٧.٨٥٣٥٤٨٨.٣٣٣
الدمام	السجل التجاري	٢٠٥٠٠٦٥١٢١
مصدرة	النشاط	إنتاج الألواح المحشوة العازلة
فاكس		
٠١٣٨١٢٤٥٧٩		
الرمز البريدي		
٣١٤٢٥		
تاريخه		
١٤٤٣٠/٠٥/٢٤ هـ		

يوافق المركز الوطني للمراقبة على الالتزام البيئي على النشاط الموضح أعلاه من الناحية البيئية مع مراعاة اللوائح والأنظمة الصادرة من الجهات الأخرى ذات العلاقة والالتزام بنظام البيئة ولوائحه التنفيذية والاشتراطات المرفقة مع هذا التصريح وتنتهي صلاحيته في ١٤٤٥/٥/٩ هـ



مدير عام التراخيص والتصاريح

أنور بن مبخوت النهدي



رقم الرخصة : 5941442227013610  
تاريخ الانتهاء : 1445/3/29

## رخصة تشغيل

	شركة مكونات البناء شركة الشخص الواحد			يرخص ل :
رسم توضيحي للموقع	1444/5/23	تاريخ الانتهاء :	1430/5/24	تاريخه :
 <p>شركة مكونات البناء شركة الشخص الواحد</p>	2050065121			رقم السجل التجاري :
	الدمام الثانية			المدينة الصناعية :
	811601			رقم العقد :
	005MM00022			موقع العقار :
عقد الإيجار ساري حتى : 1455/7/22 هـ	<p><b>الشروط والأحكام:</b></p> <p>1. تعني هذه الرخصة الإذن بتشغيل المنشأة وأن المرخص له بتشغيل هذه المنشأة هو المشغل الحقيقي له وفق كيانه القانوني وزايجته وسجلاته ولا يخفى لصاحب المنشأة التنازل عن التشغيل والرخصة أو أي جزء منها للغير.</p> <p>2. يلتزم المرخص له بالتقيد بالـ شروط والالتزامات المكتوبة في هذه الرخصة وكافة الأنظمة واللوائح والشروط والتعليمات الصادرة من "مدن"، ويتم الرجوع للأنظمة واللوائح السارية المعمول بها في المملكة العربية السعودية فيما لم يرد بشأنه تنظيم لدى "مدن".</p> <p>3. يلتزم المرخص له بتجديد هذه الرخصة خلال مدة لا تزيد عن 15 يوما بعد انتهائها.</p>			





رقم الشهادة: ١٢٠٠٣٤٣٤٨  
التاريخ: ١٤٤٣/١٠/٢٢ هـ  
الرقم المميز: ٣١١٣٣٣٦٩٣



الهيئة العامة للزكاة والدخل  
General Authority of Zakat & Tax

المملكة العربية السعودية  
الهيئة العامة للزكاة والدخل  
General Authority of Zakat & Tax

## شهادة CERTIFICATE

تشهد الهيئة العامة للزكاة والدخل بأن المكلف / مصنع شركة مكونات البناء  
شركة رقم ٧٠٠١٦٣١٨٠٨ وسجل تجاري رقم ٢٠٥٠٠٦٥١٢١  
قدم إقراره عن الفترة المنتهية في ٢٠٢٠/١٢/٣١ م

وقد منح هذه الشهادة لتمكينه من إنهاء جميع معاملاته بما في ذلك صرف مستحقاته  
النهائية عن العقود.

يسري مفعول هذه الشهادة حتى تاريخ ١٤٤٤/١٠/١٠ هـ الموافق ٢٠٢٣/٠٤/٣٠ م.  
(العاشر من شوال ألف و أربعمائة و أربعة و أربعون هجري)



الختم الرسمي

هذه الوثيقة مستخرجة من النظام الآلي ولا تحتاج إلى توقيع  
لا يعتد بهذه الشهادة إلا بعد التحقق من موقع الهيئة [www.gazt.gov.sa](http://www.gazt.gov.sa)



رؤية  
2030  
المملكة العربية السعودية  
KINGDOM OF SAUDI ARABIA

## ترخيص منشأة صناعية

### استثمار وطني



رمز المنشأة	٣٢١١٠٣	تاريخ الترخيص	١٤٤١-١١-٢٤	تاريخ القرار	١٤٤١-١١-٢٤
نوع القرار	تعديل	رقم القرار	٤١١١٠٢١٠٥٤٩٤	تاريخ الانتهاء	١٤٤٤-١١-٢٣

اسم المنشأة الصناعية	شركة مكونات البناء شركة الشخص الواحد	هاتف	+٩٦٦٥٤٥٢٠٠٣٣٣
السجل التجاري للمنشأة الصناعية	٢٠٥٠٠٦٥١٢١	فاكس	(N26.267085354880333 ,E49.97660279273987)
مالك المنشأة	شركة مكونات البناء شركة الشخص الواحد	موقع المنشأة الصناعية	المنطقة الشرقية
رقم السجل التجاري الرئيسي	٢٠٥٠٠٦٥١٢١	المنطقة	المدام
النشاط الرئيسي	معالجة وطلاء المعادن بالمعالجات بالآلات / ٢٥٩٢	المدينة	
عدد العمالة	١٩٠	مائة و تسعون فرداً	
حجم الاستثمار	٩٧٦٠٢٠٥٠٠٠٠	سبعة و تسعون مليون و ستمائة و ثلاثة ألفا و خمسون ريال	

رمز المنتج	وصف المنتج	النشاط الصناعي	الطاقة الانتاجية	الوحدة
٧٢٢٥٩٩٠٠	صفائح معدنية مضغوطة ومغزولة	٢٥٩٢١١ / معالجة وطلاء المعادن بالمقل والتلميع	٣٠٠٠٠٠٠٠	متر مربع
٧٦١٠٩٠٥٠	الواح المنيوم لتغليف وتكسية البنية	٢٥١١٥٩ / صناعة وتركيب المنتجات المعدنية المصنوعة من أجزاء في الوحدة ذاتها والمستخدمه في البناء والتشييد وأشغال معدنية مماثلة أخرى	٦٠٠٠٠٠	متر مربع
٧٢١٦١٩٠٠	قطعاعات حديدية مشكلة على البارد	٢٥٩١١٠ / صناعة منتجات معدنية تامة وشبه تامة الصنع بالطرق ، أو الكبس ، أو السبك والدلفنة	٧٠٠٠	طن

وزير الصناعة والثروة المعدنية

بندر بن إبراهيم الخريف





رقم الشهادة : ١٢٠٨١٥٥٤١  
التاريخ : ١٤٤٢/١١/٧ هـ  
الرقم المميز : ٣١٠٣٣٣٦٩٣



الهيئة العامة للزكاة والدخل  
General Authority of Zakat & Tax

المملكة العربية السعودية  
الهيئة العامة للزكاة والدخل  
General Authority of Zakat & Tax

## شهادة CERTIFICATE

تشهد الهيئة العامة للزكاة والدخل بأن المكلف / مصنع شركة مكونات البناء  
شركة رقم ٧٠٠٦٣١٨٠٨ وسجل تجاري رقم ٢٠٥٠٠٦٥١٢١  
قدم إقراره عن الفترة المنتهية في ٢٠٢٠/١٢/٣١ م

وقد منح هذه الشهادة لتمكينه من إنهاء جميع معاملاته بما في ذلك صرف مستحقاته  
النهائية عن العقود.

يسري مفعول هذه الشهادة حتى تاريخ ١٤٤٣/٠٩/٢٩ هـ الموافق ٢٠٢٢/٠٤/٣٠ م.  
(التاسع والعشرون من رمضان ألف و أربعمائة و ثلاثة و أربعون هجري)



الختم الرسمي

هذه الوثيقة مستخرجة من النظام الآلي ولا تحتاج إلى توقيع  
لا يعتد بهذه الشهادة إلا بعد التحقق من موقع الهيئة [www.gazt.gov.sa](http://www.gazt.gov.sa)



تاريخ الترخيص : ١٤٣٩/٠٢/٢٣ هـ  
الرقم المميز : ٣١٠١٣٣٦٩٣



المملكة العربية السعودية  
الهيئة العامة للزكاة والدخل  
GENERAL AUTHORITY OF ZAKAT & TAX  
(١٨٥)

**شهادة**  
CERTIFICATE

**شهادة تسجيل في ضريبة القيمة المضافة**  
VAT registration certificate

تشهد الهيئة العامة للزكاة والدخل بأن المكلف : مصنع شركة مكونات البناء  
مسجل في ضريبة القيمة المضافة بتاريخ : ١٤٣٩/٠٢/٢٣ هـ ، وتحمل الرقم الضريبي : ٣١٠١٣٣٦٩٣٠٠٠٠٣

عنوان المركز الرئيسي :  
المدينة : الحي :  
صندوق البريد : الرمز البريدي :  
الهاتف : ٠٠٩٦٦٥٤٧٢٨٧٩٧٨

الهيئة العامة للزكاة والدخل



هذه الوثيقة مرسله من النظام الآلي ولا تحتاج إلى توقيع

التاريخ  
الموافق  
١٤٤٣/١٠/٠٧  
٠٨/٠٥/٢٠٢٢  
رمز الشهادة ٤٦٠٦٩٦٣١

## شهادة

إسم المنشأة : شركة مكونات البناء

الدمام  
السعودية

رقم الإشتراك : ٥٠٣٤٤٢٠٧٨

رقم السجل التجاري: ٢٠٥٠٠٦٥١٢١

مصدره :

رقما	كتابة	عدد المشتركين السعوديين
٢٨	ثمانية و عشرون مشتركا	عدد المشتركين غير السعوديين
٧٤	أربعة و سبعون مشتركا	المجموع
١٠٢	مائة و اثنان مشتركا	

تشهد المؤسسة العامة للتأمينات الإجتماعية بأن المنشأة المذكورة أعلاه قد أوفت بالتزاماتها تجاه المؤسسة وفق البيانات المقدمة منها حتى تاريخ إصدار هذه الشهادة ، والتي تم منحها لتقديمها لأية جهة تطلبها ، وهي صالحة لجميع الأغراض التي نص عليها نظام التأمينات الإجتماعية في المادة (١٩/٦) منه.

هذه الشهادة سارية المفعول حتى ١٤٤٣/١١/٠٧ هـ.

أو عن طريق استخدام  
الرمز المعرف التالي :

يلزم التحقق من صحة وصلاحيه الشهادة عبر زيارة الرابط  
أدناه في الموقع الإلكتروني للمؤسسة العامة للتأمينات الإجتماعية



[www.gosi.gov.sa/vc](http://www.gosi.gov.sa/vc)

( الشهادة معتمدة من صاحب الصلاحيه ولا تحتاج إلى توقيع أو ختم )

ننهادة 

[www.gosi.gov.sa](http://www.gosi.gov.sa)  
800 1243344





وزارة التجارة والاستثمار  
Ministry of Commerce and Investment

٧٠٠١٦٣١٨٠٨

٢٥٥٠٦٥١٢١

١٤٣٠/٥/٢٤ هـ

الرقم:

التاريخ:

## شهادة تسجيل الشركة

الاسم التجاري للشركة: شركة مكونات البناء شركة الشخص الواحد

سعودي

جنسيتها:

نوعها: ذات مسئولية محدودة

١٤٥٥/٥/٢٣ هـ

١٤٣٠/٥/٢٤ هـ

تبدأ من:

مدة الشركة: ٢٥ سنة

مركزها الرئيسي: الدمام المدينة الصناعية

٨٤٧٣٣٣٣

هاتف:

٣١٤٢٥

الرمز البريدي:

١٤٤٤٠

ص ب:

النشاط: صناعة صفائح والأواح ولقائف شريطية وقضبان وأسياخ وزوايا وأسلاك ومقاطع بكافة أشكالها\*، مصنوعات معدنية عادية غير حديدية ، تشمل ( (أسلاك ، مواسير ، أنابيب ، مساحيق ، أوراق ، صفائح ... الخ ) \*، صناعة وتركيب النوافذ والأبواب\*، صناعة منتجات معدنية تامة وشبه تامة الصنع بالطرق ، أو الكبس ، أو السبك والدفنعة\*، معالجة وظلي المعادن بالصقل والتلميع\*.

\*النشاط يتطلب الحصول على ترخيص من وزارة الطاقة والصناعة والثروة المعدنية

رأس المال: ٢٥٠٠٠٠٠٠ ريال سعودي

١ نواف بن محمد بن عبدالله الزامل

المدبرون:

٢

٤

٦

٨

١٠

١٢

سلطات المدير/المدبرون: حسب ما نص عليه عقد الشركة

الدمام

الدمام

١٤٤٤/٥/٢٠ هـ

١٤٠٥١٧٤٤ رقم

١٤٤٤/٥/٢٣ هـ

عبد المحسن بن ابراهيم الحماد

مدير السجل التجاري للشركات:

التوقيع:



To verify the information of this certificate visit <http://v.mci.gov.sa> على هذه الشهادة بالدخول على

# ZS CERTIFICATE

**BUILDING COMPONENT SOLUTIONS CO. LTD.**

Single Person Limited Liability Company  
Head Office  
P.O. Box 14441 Dammam 31421 Saudi Arabia  
Phone (966 13) 812 4571, 72, 73 - Fax : (966 13) 812 4579  
C.R. No. 2050065121 Paid up Capital (SR 25,000,000)  
marketing@bcoms.com



**شركة مكونات البناء**

شركة شخص واحد - ذات مسئولية محدودة  
المكتب الرئيسي  
ص.ب : ١٤٤٤١ الدمام ٣١٤٢١ المملكة العربية السعودية  
هاتف : ٧٢, ٧٣, ٨١٢ ٤٥٧١ - فاكس : (٩٦٦ ١٣) ٨١٢ ٤٥٧٩  
س.ت : ٢٥٠٠٦٥١٢١ رأس المال ( ٢٥,٠٠٠,٠٠٠ ريال سعودي )  
marketing@bcoms.com

19 November 2019

## "To Whom it May Concern"

This is to certify that Building Component Solutions LLC which is dealing in production and sale of Tempcon – sandwich panels and building components is a unit of Zamil Steel Company, hence all dealing and financial transactions may please be done with BCOMS same as dealing with Zamil Steel company. Please consider BCOMS as part of Zamil industrial.

Regards,

  
Saeed M. Al-Qarni  
Corporate Admin Director



Wisel Address  
Dammam Building No. 3312 - Unit No. 2  
Zipcode 34325 Additional No. 7037

www.bcoms.com

بريد وأصل  
الدمام رقم المبنى ٣٣١٢ رقم الوحدة ٢  
الرمز البريدي ٣٤٣٢٥ الرقم الإضافي ٧٠٣٧



شركة مكونات البناء شركة الشخص الواحد



السجل التجاري : 2050065121

## رمزك التجاري QR Code

من خلاله يمكنك التحقق المباشر من معلومات:

- السجل التجاري
- رخصة البلدية
- شهادة السعودة
- برنامج نطاقات
- شهادة الزكاة
- الغرفة التجارية

## شهادة الاشتراك - Membership Certificate



Membership No : 129898

رقم الاشتراك : 129898

Classification : First

الدرجة : الأولى

Date of Issue : 28/01/2020

تاريخ الاصدار : 03/6/1441

Asharqia Chamber Certifies that :

تشهد الغرفة التجارية الصناعية بالمنطقة الشرقية بأن :

Building components company

شركة مكونات البناء

Commercial Register No: 2050065121

المقيدة بالسجل التجاري / الترخيص رقم: 2050065121

Registered with Chamber since : 24/05/2009 and

مشاركة في الغرفة منذ : 29/05/1430

the certificate expires on : 17/12/2022

ويتهي سريان هذه الشهادة في : 23/05/1444

,14440, الدمام, 31425

,31425, الدمام, 14440



يمكنك التحقق من صحة هذه الشهادة  
<https://www.chamber.org.sa/VerifyCert>



## Saudization Certificate

### شهادة سعودة

تاريخ الإصدار : ١٤٤٣/١٧/١٧  
تاريخ صلاحية الشهادة : ١٤٤٤/١٧/٢٠  
رقم الشهادة : ٢٠٠٠٢٢٠٥٠٠٩٩٩٩

اسم المنشأة: شركة مكونات البناء شركة الشخص الواحد

رقم الملف: ٨١٤٩٠-٤

سجل تجاري: ٢٠٥٠٠٦٥١٢١

الصادر من: الدمام

تشهد وزارة العمل والتنمية الاجتماعية بأن المنشأة المذكورة أعلاه حققت نسب التوطين المطلوبة منها..  
وتم منحها هذه الشهادة حسب طلبها  
(الشهادة معتمدة من صاحب الصلاحية ولا تحتاج إلى توقيع أو ختم)

BCOMS

# CERTIFICATE OF PRODUCT CONFORMITY



## CERTIFICATE OF PRODUCT CONFORMITY

Dubai Central Laboratory Department (DCLD) of Dubai Municipality  
hereby attests that the product(s)

### PUR/PIR Thermal Insulation

(Details as per the attached Scope of Certification)

manufactured by:

### BUILDING COMPONENT SOLUTIONS LLC

Al Hassa Street, Site 4, 2nd Industrial City, Dammam, KSA

have been assessed in accordance with DCLD Document Ref. No. DM-DCLD-RD-DP21-2001 (IC) "General Rules for DM third party product certification system through factory assessment" and the relevant Specific Rules, and were found in conformity with the standard specification:

### BS EN 13165: 2012

Accordingly, DCLD hereby authorizes the above manufacturer  
to affix the DCL Product Conformity Mark on the above-mentioned product(s).

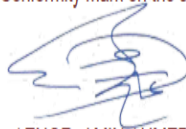

for / ENGR. AMIN AHMED AMIN  
Director, Dubai Central Laboratory Department  
Dubai Municipality



Certificate No: CL14020215  
Valid Until: 29/06/2022



Current Issue Date: 30/06/2021  
Original Issue Date: 30/06/2014



The attached Scope of Certification bearing the same Certificate Number forms an integral part of this Certificate.  
This Certificate is an electronic document subject to the Terms and Conditions of the Product Certification System and shall not be reproduced except in full.

# FM APPROVAL



## Certificate of Compliance

This certificate is issued for the following:

Temparch, Tempcon, Firecon, Firewall

Prepared for:

Building Component Solutions (LLC)  
Industrial Area 2  
PO Box 14441  
Dammam 31424  
Saudi Arabia

FM Approvals Class: 4880, 4881 for Temparch, Tempcon, Firecon, Firewall  
4471 for Tempcon, Firecon

Approval Identification: 3049831      Approval Granted: 3/15/2016

To verify the availability of the Approved product, please refer to [www.ApprovalGuide.com](http://www.ApprovalGuide.com) and [www.RoofNav.com](http://www.RoofNav.com).

Said Approval is subject to satisfactory field performance, continuing Surveillance Audits, and strict conformity to the constructions as shown in the Approval Guide and RoofNav, an online resource of FM Approvals.



---

Cynthia E. Frank  
AVP—Manager of Materials  
FM Approvals  
1151 Boston-Providence Turnpike  
Norwood, MA 02062



Note: BCOMS can provide FM approved panels upon customer request. For further information please contact our sales.

# ISO- 9001 (QUALITY MANAGEMENT SYSTEM)

## ABS Quality Evaluations

### Certificate Of Conformance

This is to certify that the Quality Management System of:

**Building Component Solutions (BCOMS)**  
Site 4, Al Hassa Street, 2nd Industrial City  
P.O. Box 14441  
Dammam, Kingdom 31424  
Saudi Arabia

has been assessed by ABS Quality Evaluations, Inc. and found to be in conformance with the requirements set forth by:

**ISO 9001:2015**

The Quality Management System is applicable to:

**MANUFACTURE AND SUPPLY OF INSULATED PANELS AND OTHER RELATED ACCESSORIES**

This certificate may be found on the ABS QE Website ([www.abs-qe.com](http://www.abs-qe.com)). For certificates issued in the People's Republic of China information may also be verified on the CNCA website ([www.cnca.gov.cn](http://www.cnca.gov.cn)).

Certificate No:	47425
Certification Date:	14 May 2012
Effective Date:	28 April 2021
Expiration Date:	13 May 2024
Revision Date:	04 May 2021

  
 Dominic Townsend, President



Validity of this certificate is based on the successful completion of the periodic surveillance audits of the management system defined by the above scope and is contingent upon prompt written notification to ABS Quality Evaluations, Inc. of significant changes to the management system or components thereof.

ABS Quality Evaluations, Inc. 1701 City Plaza Drive, Spring, TX 77389, U.S.A.  
Validity of this certificate may be confirmed at [www.abs-qe.com/cert\\_validation](http://www.abs-qe.com/cert_validation).

Copyright 2011-2021 ABS Quality Evaluations, Inc. All rights reserved.

# ISO- 14001 (ENVIRONMENTAL MNGT. SYS.)

## ABS Quality Evaluations

### Certificate Of Conformance

This is to certify that the Environment Management System of:

**Building Component Solutions (BCOMS)**

**Site 4, Al Hassa Street, 2nd Industrial City**

**P.O. Box 14441**

**Dammam, Kingdom 31424**

**Saudi Arabia**

has been assessed by ABS Quality Evaluations, Inc. and found to be in conformance with the requirements set forth by:

**ISO 14001:2015**

The Environment Management System is applicable to:

**MANUFACTURE AND SUPPLY OF INSULATED PANELS AND OTHER RELATED ACCESSORIES**

This certificate may be found on the ABS QE Website ([www.abs-qe.com](http://www.abs-qe.com)). For certificates issued in the People's Republic of China information may also be verified on the CNCA website ([www.cnca.gov.cn](http://www.cnca.gov.cn)).

Certificate No:	48652
Last Expiry Date:	06 January 2021
Original Approval Date:	07 January 2016
Effective Date:	08 February 2021
Expiration Date:	06 January 2024
Revision Date:	09 February 2021



**Dominic Townsend, President**



Validity of this certificate is based on the successful completion of the periodic surveillance audits of the management system defined by the above scope and is contingent upon prompt, written notification to ABS Quality Evaluations, Inc. of significant changes to the management system or components thereof.

ABS Quality Evaluations, Inc. 1701 City Plaza Drive, Spring, TX 77389, U.S.A.  
Validity of this certificate may be confirmed at [www.abs-qe.com/cert\\_validation](http://www.abs-qe.com/cert_validation).

Copyright 2011-2021 ABS Quality Evaluations, Inc. All rights reserved.

# OHSAS 45001:2018 (OCCUPATIONAL HEALTH & SAFETY)

## ABS Quality Evaluations

### Certificate Of Conformance

This is to certify that the Health and Safety Management System of:

**Building Component Solutions (BCOMS)**

**Site 4, Al Hassa Street, 2nd Industrial City**

**P.O. Box 14441**

**Dammam, Kingdom 31424**

**Saudi Arabia**

has been assessed by ABS Quality Evaluations, Inc. and found to be in conformance with the requirements set forth by:

**ISO 45001:2018**

The Health and Safety Management System is applicable to:

**MANUFACTURE AND SUPPLY OF INSULATED PANEL AND RELATED ACCESSORIES**

This certificate may be found on the ABS QE Website ([www.abs-qe.com](http://www.abs-qe.com)). For certificates issued in the People's Republic of China information may also be verified on the CNCA website ([www.CNCA.gov.cn](http://www.CNCA.gov.cn)).

Certificate No: 52090  
Certification Date: 25 November 2015  
Effective Date: 14 November 2021  
Expiration Date: 24 November 2024  
Revision Date: 23 November 2021



Dominic Townsend, President



Validity of this certificate is based on the successful completion of the periodic surveillance audits of the management system defined by the above scope and is contingent upon prompt written notification to ABS Quality Evaluations, Inc. of significant changes to the management system or components thereof.

ABS Quality Evaluations, Inc. 1701 City Plaza Drive, Spring, TX 77389, U.S.A  
Validity of this certificate may be confirmed at [www.abs-qe.com/cert\\_validation](http://www.abs-qe.com/cert_validation).

Copyright 2011-2021 ABS Quality Evaluations, Inc. All rights reserved.

# AIR INFILTRATION AND WATER PENETRATION TEST



THOMAS BELL-WRIGHT  
INTERNATIONAL CONSULTANTS

PO BOX 26385 DUBAI UAE  
T +971 (0) 4 333 2692 F +971 (0)4 333 2693  
[www.bell-wright.com](http://www.bell-wright.com)

**FINAL REPORT  
FOR TESTING  
METAL SHEET INSULATED WALL PANELS  
(TCSQ 75)  
FOR  
BUILDING COMPONENT SOLUTIONS LLC  
Dammam, SAUDI ARABIA**

**Aircraft Maintenance Building**  
Date: March 26, 2015  
File No: PB108  
File Name: PB108 AircraftMaintenanceTCSQ75\_FR.lwp

Copyright©

Final Report shall not be reproduced without full written approval of Thomas Bell-Wright International Consultants.

# AIR INFILTRATION AND WATER PENETRATION TEST



THOMAS BELL-WRIGHT  
INTERNATIONAL CONSULTANTS

## ACCREDITATION

### TESTING

ISO 17025 : General requirements for the competence of testing and calibrating laboratories by

1. UKAS - Testing Laboratory 4439
2. International Accreditation Service (IAS) - Testing Laboratory TL-626
3. ENAS - Testing Laboratory NAL 008

[www.ukas.com](http://www.ukas.com)   [www.esma.gov.ae](http://www.esma.gov.ae)   [www.iasonline.org](http://www.iasonline.org)

### INSPECTION

ISO 17020 : Conformity Assessment - Requirements for the operation of various types of bodies performing inspection by

International Accreditation Service (IAS) as a Inspections Agencies (AC98) - Inspection Agency AA-748

Accredited to conduct Inspections as per International Building Code (IBC) Chapter 17, Section 1704 and Section 1705 by

International Accreditation Service or IAS as a Special Inspections Agency (AC291) - Special Inspection Agency SIA-211

### CERTIFICATION

ISO/IEC 17065:2012 : Conformity Assessment - Requirements for bodies certifying products, processes and services by

UKAS - Certification Body 6762

## MEMBERSHIPS

Members of European Group of Organization for Fire Testing, Inspection and Certification

[www.egolf.org.uk](http://www.egolf.org.uk)

Member of International Trade Council

[www.thetradecouncil.com](http://www.thetradecouncil.com)

Member of Centre for Window and Cladding Technology

[www.cwct.co.uk](http://www.cwct.co.uk)

The work which is a subject of this document falls wholly or partly under the accreditation checked below

ISO 17025	UKAS	<input checked="" type="checkbox"/>	ISO 17025	ENAS	<input checked="" type="checkbox"/>
ISO 17025	IAS	<input type="checkbox"/>	ISO 17020	IAS	<input type="checkbox"/>
AC 291	IAS	<input type="checkbox"/>	ISO 17065	UKAS	<input type="checkbox"/>

It is not within our scope  



# AIR INFILTRATION AND WATER PENETRATION TEST



I. General Parameters

PROJECT NAME:	<b>Aircraft Maintenance Building</b>	
TEST SEQUENCE		
Test 1	Air infiltration test	ASTM E 283-04
Test 2	Static Water Penetration test	ASTM E 331-00
RELEVANT INFORMATION		
Type	Insulated Panels TCSQ 75	
Materials		
Panel size	3.0 m in height X 3.0 m width	
Flat / Curve	Corrugated wall cladding	
Employer		
Facade Consultant		
Roofing Contractor	BUILDING COMPONENT SOLUTIONS LLC	

II. Witnesses

NAME	COMPANY	TELEPHONE
Mr. Fouad Malazi	BUILDING COMPONENT SOLUTIONS LLC	

III. Wall Panel Wall Test Result

Testing results were all recorded as mentioned below with reference to test sheets attached, witnessed by representatives listed above during the course of testing.

IV. Test Summary

A. Test History

No.	TEST	DATE & TIME	PASS / FAIL
1	Air infiltration test, ASTM E 283-04	March 25, 2015 11:30 AM	PASSED
<ul style="list-style-type: none"> <li>▪ Differential test pressure = 75 Pascals</li> <li>▪ Permitted leakage for glazing = 1.08 m<sup>3</sup>/hr/m<sup>2</sup></li> <li>▪ Specimen Area = 9 m<sup>2</sup></li> <li>▪ Total allowable leakage for the whole specimen = 9.72 m<sup>3</sup>/hr</li> </ul> <p>Results:</p> <ul style="list-style-type: none"> <li>▪ Specimen sealed with polyethylene sheet, Extraneous air leakage (Q<sub>e</sub>) = 26.0 m<sup>3</sup>/hr</li> <li>▪ Total air leakage (Q<sub>T</sub>) for chamber plus specimen = 28.1 m<sup>3</sup>/hr</li> <li>▪ Specimen air leakage (Q<sub>s</sub>) = 2.1m<sup>3</sup>/hr at standard condition, less than the permissible (9.72 m<sup>3</sup>/hr) and so the test was recorded passed.</li> </ul>			
2	Static water penetration test, ASTM E 331-00	March 25, 2015 11:52 AM	PASSED
<p>The specimen was covered with 25 nozzles, each producing 1/3 US gallons per minute of water volume flow (1.26 L/min), thus producing a total of 8.33 US gallons per minute of water spray (31.53 L/min), applied in the entire test specimen during the test.</p> <ul style="list-style-type: none"> <li>▪ Differential test pressure = 300 Pascals</li> <li>▪ Test duration = 15 minutes</li> </ul>			

File Name: PB108 AircraftMaintenanceTCSQ75\_FR.lwp

# AIR INFILTRATION AND WATER PENETRATION TEST



THOMAS BELL-WRIGHT  
INTERNATIONAL CONSULTANTS

PO BOX 26385 DUBAI UAE  
T +971 (0) 4 333 2692 F +971 (0)4 333 2693  
[www.bell-wright.com](http://www.bell-wright.com)

**FINAL REPORT  
FOR TESTING  
METAL SHEET INSULATED WALL PANELS  
(TAUQ75)  
FOR  
BUILDING COMPONENT SOLUTIONS LLC  
Dammam, SAUDI ARABIA**

**Air Craft Maintenance Building**  
Date: March 25, 2015  
File No: PB108  
File Name: PB108 AircraftHangarFlat\_FR.lwp

Copyright©

Final Report shall not be reproduced except in full without written approval of Thomas Bell-Wright International Consultants.

# AIR INFILTRATION AND WATER PENETRATION TEST



THOMAS BELL-WRIGHT  
INTERNATIONAL CONSULTANTS

## ACCREDITATION

### TESTING

ISO 17025 : General requirements for the competence of testing and calibrating laboratories by

1. UKAS - Testing Laboratory 4439
2. International Accreditation Service (IAS) - Testing Laboratory TL-626
3. ENAS - Testing Laboratory NAL 008

[www.ukas.com](http://www.ukas.com)   [www.esma.gov.ae](http://www.esma.gov.ae)   [www.iasonline.org](http://www.iasonline.org)

### INSPECTION

ISO 17020 : Conformity Assessment - Requirements for the operation of various types of bodies performing inspection by

International Accreditation Service (IAS) as a Inspections Agencies (AC98) - Inspection Agency AA-748

Accredited to conduct Inspections as per International Building Code (IBC) Chapter 17, Section 1704 and Section 1705 by

International Accreditation Service or IAS as a Special Inspections Agency (AC291) - Special Inspection Agency SIA-211

### CERTIFICATION

ISO/IEC 17065:2012 : Conformity Assessment - Requirements for bodies certifying products, processes and services by

UKAS - Certification Body 6762

## MEMBERSHIPS

Members of European Group of Organization for Fire Testing, Inspection and Certification

[www.egolf.org.uk](http://www.egolf.org.uk)

Member of International Trade Council

[www.thetradeCouncil.com](http://www.thetradeCouncil.com)

Member of Centre for Window and Cladding Technology

[www.cwct.co.uk](http://www.cwct.co.uk)

The work which is a subject of this document falls wholly or partly under the accreditation checked below

ISO 17025	UKAS	<input checked="" type="checkbox"/>	ISO 17025	ENAS	<input checked="" type="checkbox"/>
ISO 17025	IAS	<input type="checkbox"/>	ISO 17020	IAS	<input type="checkbox"/>
AC 291	IAS	<input type="checkbox"/>	ISO 17065	UKAS	<input type="checkbox"/>

It is not within our scope  



# AIR INFILTRATION AND WATER PENETRATION TEST



I. General Parameters

PROJECT NAME:	<b>AIRCRAFT MAINTENANCE BUILDING</b>	
TEST SEQUENCE		
Test 1	Air infiltration test	ASTM E 283-04
Test 2	Static Water Penetration test	ASTM E 331-00
RELEVANT INFORMATION		
Type	Wall - Metal Sheets	
Materials		
Panel size	3.0 m in height X 3.0 m width	
Flat / Curve	Straight wall (TAUQ 75)	
Employer		
Facade Consultant		
Roofing Contractor	BUILDING COMPONENT SOLUTIONS LLC	

II. Witnesses

NAME	COMPANY	TELEPHONE
Mr. Fouad Malazi	BUILDING COMPONENT SOLUTIONS LLC	

III. Wall Panel Wall Test Result

Testing results were all recorded as mentioned below with reference to test sheets attached, witnessed by representatives listed above during the course of testing.
--

IV. Test Summary

A. Test History

No.	TEST	DATE & TIME	PASS / FAIL
1	Air infiltration test, ASTM E 283-04	March 25, 2015 11:30 AM	PASSED
<ul style="list-style-type: none"> <li>▪ Differential test pressure = 75 Pascals</li> <li>▪ Permitted leakage for glazing = 1.08 m<sup>3</sup>/hr/m<sup>2</sup></li> <li>▪ Specimen Area = 9 m<sup>2</sup></li> <li>▪ Total allowable leakage for the whole specimen = 9.72 m<sup>3</sup>/hr</li> </ul> <p>Results:</p> <ul style="list-style-type: none"> <li>▪ Specimen sealed with polyethylene sheet, Extraneous air leakage (Q<sub>e</sub>) = 30.1 m<sup>3</sup>/hr</li> <li>▪ Total air leakage (Q<sub>T</sub>) for chamber plus specimen = 31.9 m<sup>3</sup>/hr</li> <li>▪ Specimen air leakage (Q<sub>s</sub>) = 1.8m<sup>3</sup>/hr at standard condition, less than the permissible (9.72 m<sup>3</sup>/hr) and so the test was recorded passed.</li> </ul>			
2	Static water penetration test, ASTM E 331-00	March 25, 2015 11:52 AM	PASSED
<p>The specimen was covered with 25 nozzles, each producing 1/3 US gallons per minute of water volume flow (1.26 L/min), thus producing a total of 8.33 US gallons per minute of water spray (31.53 L/min), applied in the entire test specimen during the test.</p> <ul style="list-style-type: none"> <li>▪ Differential test pressure = 300 Pascals</li> <li>▪ Test duration = 15 minutes</li> </ul>			

File Name: PB108 AircraftHangarFlat\_FR.lwp

## SAUDI ELECTRICITY COMPANY VENDOR NUMBER



Date: 14.01.2014

Vendor Name: Building Component Solutions LLC

P.O. Box 14441

Dammam 31424

C. R. NO: 2050065121

### SUBJECT: VENDOR'S REGISTRATION NOTIFICATION

Dear Sir,

We are pleased to inform that your commercial documents have been evaluated and your company is now registered with Saudi Electricity

Company under **Vendor No ( 2005773 )**,

for materials:

INSULATION AND SEALING MATERIALS	ROOFING AND SIDING MATERIALS
-	-

### Application Accepted for Building Component Solutions(BCOMS) Your Registration with SABIC has been Approved.

Dear Sir,

We thank you for your interest in SABIC.

We are pleased to inform you that your request has been approved by **SABIC** under vendor # 506227.

We have already sent you confirmation notification on designated person's email address. In case you did not received that mail, please contact us on – [sq@sabic.com](mailto:sq@sabic.com)

Thank you.

---

Supplier Qualification Section  
Section e-Mail, Jubail Procurement Dep.  
Saudi Basic Industries Corporation  
P.O. Box 11115  
Jubail 31961  
SAUDI ARABIA  
T +966 (3) 340 2435  
F +966 (3) 340 1850  
E [SQ@SABIC.com](mailto:SQ@SABIC.com)



## ROYAL COMMISSION JUBAIL VENDOR NUMBER



**Royal Commission for  
Jubail and Yanbu (RCJY)**  
**الهيئة الملكية للجبيل وينبع**

**06/06/32**

Supplier Approved

Your information have been approved as Supplier on RCJ File Number : **RCJ000007**

**THANK  
YOU**

BCOMS